

PRODUCTION and FABRICATION
MEAT INDUSTRY MACHINERY



DESIGN and ENGINEERING
MATERIAL HANDLING EQUIPMENT

SWITCH MANUAL

INCLUDING INSTALLATION, OPERATION
MAINTENANCE, SAFETY & SPARE PARTS

Introduction To Switches	2-4
Load Capacities	4
Ordering Information	5

Switches

6006 Standard Automatic Switch #1, #2, #3, Cut-thru, Heavy Duty Cut-thru	6-10
6006 Automatic Conveyor Switch #1, #2	11 & 13
6009 Automatic Conveyor SST Type Switch #1, #2	12 & 14
6007 Standard Gear Operated Switch #1, #2, #3	15-17
6007 Gear Operated Conveyor Switch #1, #2	18-19
6008 Gear Operated Bleeding Rail Switch (extra heavy duty) #1, #2	20-21
6008 Automatic Bleeding Rail Switch (extra heavy duty) #1, #2	22-23
6010 2nd Leg Transfer Switch #1, #2	24-25
6011 Lift & Turn Switch TTL, TTR	26
8012 Counter Weight Switch #1 Only	27
6607 Power Divert Switch #1, #2	28-29
Optional Switch Dimensions	30
Switch Options	31
Switch Accessories	32
Switch Related Equipment	32
Switch Installation	33
Switch Operation	34
Switch Maintenance	34
Switch Safety	35
Warranty Information	36
Notes	37

LEFIELL COMPANY SWITCH INTRODUCTION

LeFiell company switches are designed to operate safely when used for their intended purpose. It is the purchasers responsibility to ensure proper use of the equipment and to train operators for its safe and efficient operation. It is recommended that the purchaser review the equipment operators performance periodically.

It is also the purchasers responsibility to properly install and maintain the equipment so that it can be operated safely. All LeFiell switches are affixed with operator warning labels. Operator warning signs are available. Be sure that safety rules are observed and the safety labels are maintained. This manual was written to aid the operations and maintenance personnel in the operation and/or maintenance of switches.

6006 STANDARD AUTOMATIC SWITCH

The LeFiell automatic switch eliminates manual operation in gathering to a common head rail from the c or i ends of the switch, (for c, i & s ends designation see plan view on automatic switch pages). The weight and forward motion of an approaching load along either rail actuates the switch closing one rail and opening the other. When necessary to move the load in a reverse direction, from the s end of the switch, the switch track pieces must be manually actuated by the pull handle. A direction selector option added to this switch enables the operator to select and hold the switch in either selected direction without interfering with automatic operation thus back-switching is automatic and accomplished without touching the switch.

6006 AUTOMATIC CONVEYOR SWITCH

The automatic conveyor switch operates like the standard automatic switch. The automatic mechanism operates either above the conveyor chain or to one side – out of the way. All switching time is saved and there is no delay in feeding the conveyor. The conveyor chain cannot come in contact with any part of the switch.

6006 AUTOMATIC & HEAVY DUTY CUT- THRU SWITCH

The LeFiell cut-thru switch construction provides freedom from manual switching at any point where tracks must cross at right angles. This switch has interconnected pivoted track sections which are automatically lined up by a trolley moving in either direction on either of the two tracks. No operating handle is needed. The switch is completely automatic. With this switch there are no open track ends.

6007 STANDARD GEAR OPERATED SWITCH

The LeFiell gear operated switch features a positive actuation of the double lift. This is accomplished through the use of steel gears. The difficulty in assembly and installation of conventional slide and lift arrangements is eliminated. An outstanding advantage of this switch is the ease and simplicity with which it may be installed. Installation can be accomplished in one-fourth the time formerly required since all fitting is eliminated.

6007 GEAR CONVEYOR SWITCH

The gear conveyor switch operates like the standard gear switch except the load capacity increases to 1500 lbs. Not recommended for overhead chain conveyor system.

LEFIELL COMPANY SWITCH INTRODUCTION

6008 GEAR OPERATED BLEEDING RAIL SWITCH (EXTRA HEAVY DUTY)

The LeFiell gear operated bleeding rail switch has all the fine features of the 6007 gear operated switch except it is made heavier to withstand whole carcass loads.

6008 AUTOMATIC BLEEDING RAIL SWITCH (EXTRA HEAVY DUTY)

The LeFiell automatic bleeding rail switch has all the fine features of the 6006 automatic switch except it is made heavier to withstand whole carcass load it is especially designed for use when rails converge or back switching is required.

Air operated remote control attachments are available on all automatic bleeding rail switches for control at the most convenient points.

6010 2ND TRANSFER SWITCH

The LeFiell 2nd leg transfer switch features a positive spring moving track section eliminating any manual operation the switch has a 10" offset designed to transfer the animal to a common rail after bleeding

6011 LIFT AND TURN SWITCH

The LeFiell lift and turn switch is a manually operated switch that allows product to travel right left or straight through. Ideally designed for multi-direction travel where space is limited

6012 COUNTER WEIGHT SWITCH

The LeFiell counter weight switch is automatic, and designed as an alternative to the automatic type feed-out switch it is designed as a #1 switch type only and allows the head rail to be one piece with the switch being installed independent of the head rail.

6607 POWER DIVERT SWITCH

The LeFiell power divert switch is an air or hydraulic operated switch with the curved end sloping down 2 1/2". It is especially designed for feeding into a walking beam rail from a conveyORIZED head rail.

FEED OUT SWITCH

This is an automatic conveyor switch with the curved track sloped up 2 1/2" and without a direction selector this switch is designed for the feed-out end of a walking beam system to a conveyORIZED head rail

LEFIELL COMPANY SWITCH INTRODUCTION

6009 SST AUTOMATIC SWITCH

The SST automatic conveyor switch is the next generation of the 6006 automatic conveyor switch. The sst stands for "short-lift section track" which is a clear description of one of the significant features of this new switch. The 1" to 2 1/2" shorter lift section of the SST switch guarantees less chance of vertical bending/flexing and longer lift section life. Other significant features are: steel, not sheet metal; guide tabs to improve seating of movable sections to track; threaded stud in metal tube lift pivots to reduce lift section distortions and reduce maintenance; and metal-to-metal tie rod bushings which withstand heat/cold degradation.

SAF-T-GUARD SWITCH

The Saf-T-Guard switch is an added feature for all LeFiell switches, whether they be automatic or gear operated, 500#, 1,500# or 3,000# capacity 90 degrees or 45 degrees it has been designed for one purpose only, the prevention of trolley drop-offs! It will not interfere with normal switch operations, is of durable welded construction, and uses template formed spacing to ensure exacting fit between switch and guard rail.

SWITCH LOAD CAPACITIES

1) LeFiell switches are rated for a maximum load per switch as follows:

	Max. Load (lbs) Single Trolley	Max. Load (lbs) Double Trolley
6006 Standard Automatic Switch	500	750
6006 Automatic Conveyor Switch	1,500	2000
6007 Gear Operated Switch	500	750
6007 Gear Operated Conveyor Switch <i>gear operated switches are not recommended for conveyORIZED systems.</i>	1,500	2000
6008 Bleeding Rail System (extra heavy duty) gear operated and automatic	3,000*	4000*
6010 2nd Leg Switch	1,500	2000
6011 Lift & Turn Switch	1,500	2000
6012 Counter Weight Switch	1,500	2000
6607 Power Divert Switch	1,500	2000

*For 6008 Extra Heavy Duty Switches, bridge must be welded or bolted for maximum capacity.

2) Hangers and supporting structure must be designed, fabricated and installed to rigidly support the switches for maximum load specifications.

DO NOT EXCEED MAXIMUM LOAD SPECIFICATIONS

ORDERING INFORMATION

ORDERING A NEW SWITCH

When ordering a new switch please have the following information available.

- 1) Model number and switch number
- 2) Hanger length
- 3) Galvanized finish or Stainless Steel
- 4) Any switch variations (such as 45 degree curved track sloping or an extended end bolt on bridges etc.)

Special switches are not returnable

ORDERING REPLACEMENT PARTS

When ordering parts please have the following information available.

- 1) Switch model number
- 2) Date of purchase (if available)
- 3) Part number from parts list (sp number)
- 4) Hanger length (conveyor switch only)
- 5) Galvanized finish or Stainless Steel

LeFiell recommends guard rail on switches.

The following parts list includes only those items that normally require replacement due to normal use. Replacement of any component can be supplied upon request.

Replacement parts should be ordered well in advance of expected use as availability and delivery time varies due to inventory.

SHIPPING

Inspect the equipment for any damage or shortages as soon as possible after receiving the equipment. Report any damage or shortage to the delivering carrier promptly.

6006 STANDARD AUTOMATIC SWITCH

MAXIMUM LOAD CAPACITY 500 LBS

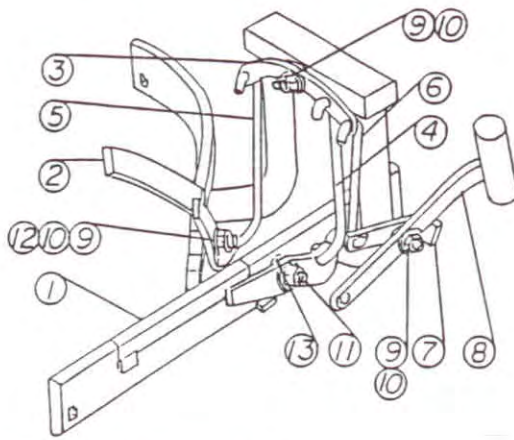

1L-90
REPLACEMENT PARTS

PART	PCS	PART DESCRIPTION	SP#
1	1	STRAIGHT LIFT TRACK ASSY.	SP079
2	1	CURVED LIFT TRACK ASSY.	SP077
3	1	ROCKER ARM	SP007
4	1	STRAIGHT LIFT LINK	SP107
5	1	CURVED LIFT LINK	SP105
6	1	SELECTOR LINK	SP109
7	1	TRIP ARM	SP008
8	1	CONTROL WEIGHT	SP005
9	4	1/2" - 13 LOCK NUT	SP120
10	8	1/2" SAE WASHER	SP009
11	2	LIFT PIVOT BOLT	SP118
12	2	1/2" - 13 JAM NUT	SP119
13	2	1/2" STD. WASHER	SP121

1L-90 = #SW024 ELECTRO-GALV.
ALSO AVAILABLE IN STAINLESS STEEL.

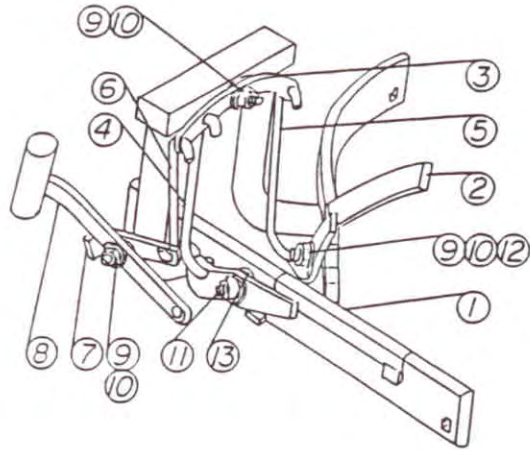

1R-90
REPLACEMENT PARTS

PART	PCS	PART DESCRIPTION	SP#
1	1	STRAIGHT LIFT TRACK ASSY.	SP080
2	1	CURVED LIFT TRACK ASSY.	SP078
3	1	ROCKER ARM	SP007
4	1	STRAIGHT LIFT LINK	SP106
5	1	CURVED LIFT LINK	SP006
6	1	SELECTOR LINK	SP108
7	1	TRIP ARM	SP008
8	1	CONTROL WEIGHT	SP005
9	4	1/2" - 13 LOCK NUT	SP120
10	8	1/2" SAE WASHER	SP009
11	2	LIFT PIVOT BOLT	SP118
12	2	1/2"-13 JAM NUT	SP119
13	2	1/2" STD. WASHER	SP121

1R-90 ~SW026 ELECTRO-GALV.
ALSO AVAILABLE IN STAINLESS STEEL.

THE ABOVE SWITCHES ARE ALSO AVAILABLE WITH A 45° CURVED TRACK IN LIEU OF A 90° CURVED TRACK. SEE SWITCH OPTIONS LISTED ON PAGE #30.

1L-45 = #SW027 ELECTRO-GALV.

1R-45 = #SW025 ELECTRO-GALV.

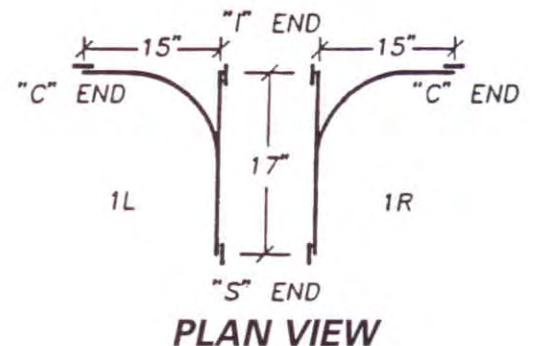

6006 STANDARD AUTOMATIC SWITCH

MAXIMUM LOAD CAPACITY 500 LBS

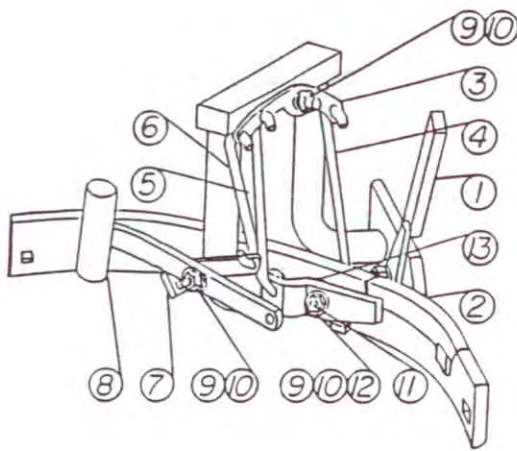

2L-90 REPLACEMENT PARTS

PART	PCS	PART DESCRIPTION	SP#
1	1	STRAIGHT LIFT TRACK ASSY.	SP080
2	1	CURVED LIFT TRACK ASSY.	SP003
3	1	ROCKER ARM	SP007
4	1	STRAIGHT LIFT LINK	SP106
5	1	CURVED LIFT LINK	SP006
6	1	SELECTOR LINK	SP108
7	1	TRIP ARM	SP008
8	1	CONTROL WEIGHT	SP005
9	4	1/2" - 13 LOCK NUT	SP120
10	8	1/2" SAE WASHER	SP009
11	2	PIVOT BOLT	SP118
12	2	1/2"-13 JAM NUT	SP119
13	2	STD. WASHER	SP121

2L-90 = SW028 ELECTRO-GALV.
ALSO AVAILABLE IN STAINLESS STEEL.

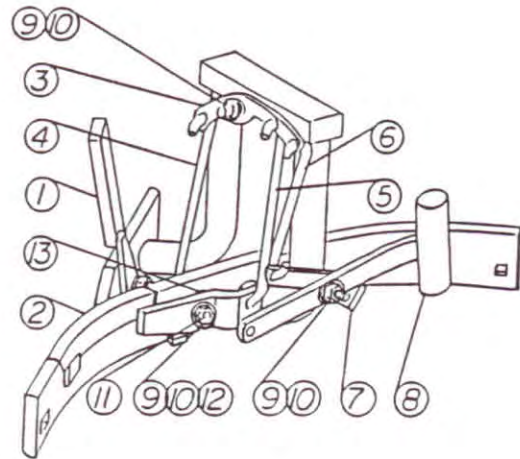

2R-90 REPLACEMENT PARTS

PART	PCS	PART DESCRIPTION	SP#
1	1	STRAIGHT LIFT TRACK ASSY.	SP079
2	1	CURVED LIFT TRACK ASSY.	SP076
3	1	ROCKER ARM	SP007
4	1	STRAIGHT LIFT LINK	SP106
5	1	CURVED LIFT LINK	SP006
6	1	SELECTOR LINK	SP108
7	1	TRIP ARM	SP008
8	1	CONTROL WEIGHT	SP005
9	4	1/2" - 13 LOCK NUT	SP120
10	8	1/2" SAE WASHER	SP009
11	2	PIVOT BOLT	SP118
12	2	1/2"-13 JAM NUT	SP119
13	2	STD. WASHER	SP121

2R-90 = #SW030 ELECTRO-GALV.
ALSO AVAILABLE IN STAINLESS STEEL.

THE ABOVE SWITCHES ARE ALSO AVAILABLE WITH A 45° CURVED TRACK IN LIEU OF A 90° CURVED TRACK. SEE SWITCH OPTIONS LISTED ON PAGE #30.

2L-45 = #SW027 ELECTRO-GALV.

2R-45 = #SW029 ELECTRO-GALV.

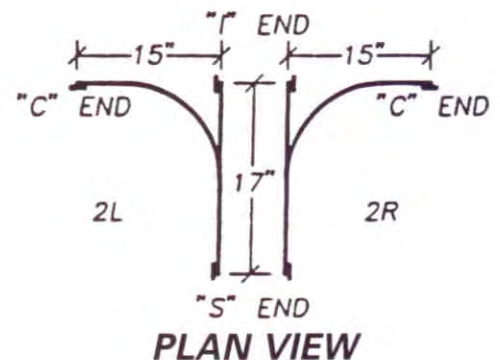

6006 STANDARD AUTOMATIC SWITCH

MAXIMUM LOAD CAPACITY 500 LBS

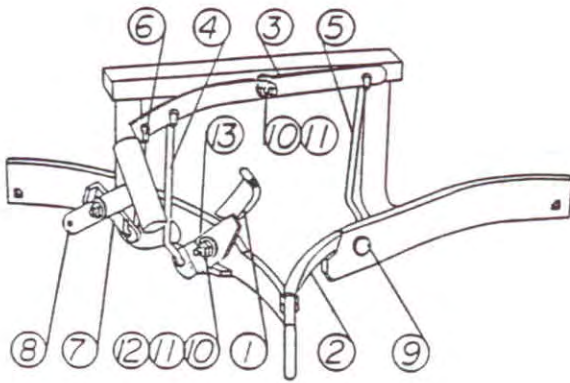

3L-90 REPLACEMENT PARTS

PART	PCS	PART DESCRIPTION	SP#
1	1	LEFT CURVED LIFT TRACK ASSY.	SP003
2	1	RIGHT CURVED LIFT TRACK ASSY.	SP078
3	1	ROCKER ARM	SP033
4	1	LEFT LIFT LINK	SP006
5	1	RIGHT LIFT LINK	SP006
6	1	SELECTOR LINK	SP108
7	1	TRIP ARM	SP008
8	1	COUNTER WEIGHT	SP005
9	2	PIVOT BOLT	SP118
10	4	1/2"-13 LOCK NUT	SP120
11	8	1/2" SAE WASHER	SP008
12	2	1/2"-13 JAM NUT	SP119
13	2	1/2" STD. WASHER	SP121

3L-90 = #SW010 ELECTRO-GALV.
ALSO AVAILABLE IN STAINLESS STEEL.

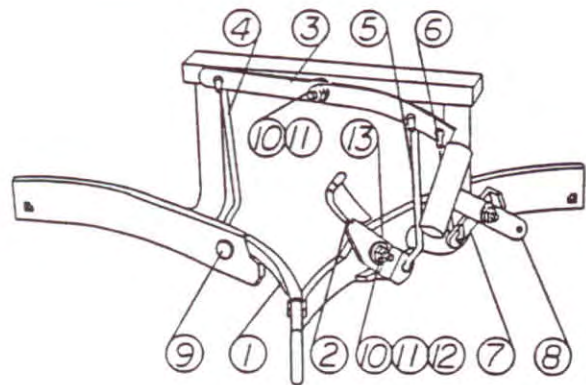

3R-90 REPLACEMENT PARTS

PART	PCS	PART DESCRIPTION	SP#
1	1	LEFT CURVED LIFT TRACK ASSY.	SP077
2	1	RIGHT CURVED LIFT TRACK ASSY.	SP076
3	1	ROCKER ARM	SP033
4	1	LEFT LIFT LINK	SP105
5	1	RIGHT LIFT LINK	SP105
6	1	SELECTOR LINK	SP109
7	1	TRIP ARM	SP008
8	1	COUNTER WEIGHT	SP005
9	2	PIVOT BOLT	SP118
10	4	1/2"-13 LOCK NUT	SP120
11	8	1/2" SAE WASHER	SP009
12	2	1/2"-13 JAM NUT	SP119
13	2	1/2" STD. WASHER	SP121

3R-90 = #SW012 ELECTRO-GALV.
ALSO AVAILABLE IN STAINLESS STEEL.

THE ABOVE SWITCHES ARE ALSO AVAILABLE WITH A 45° CURVED TRACK IN LIEU OF A 90° CURVED TRACK. SEE SWITCH OPTIONS LISTED ON PAGE #30.

3L-45 = #SW009 ELECTRO-GALV.

3R-45 = #SW011 ELECTRO-GALV.

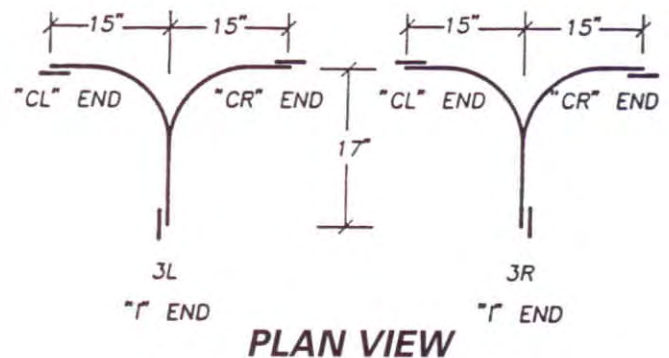

6006 STANDARD CUT-THRU SWITCH

MAXIMUM LOAD CAPACITY 500 LBS

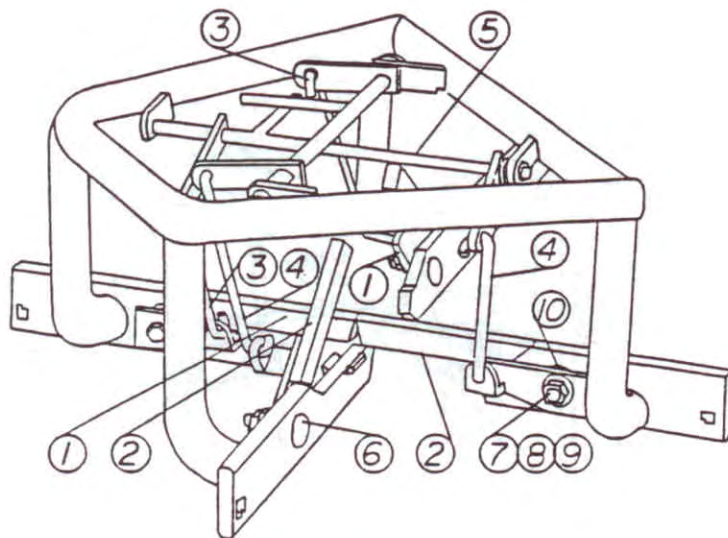

STANDARD CUT-THRU REPLACEMENT PARTS

PART	PCS	PART DESCRIPTION	SP#
1	2	RIGHT LIFT TRACK ASSY.	SP089
2	2	LEFT LIFT TRACK ASSY.	SP023
3	2	RIGHT LIFT LINK	SP116
4	2	LEFT LIFT LINK	SP024
ABOVE PARTS MUST BE ORDERED AS A SET			
5	2	OPERATING RODS	SP027
6	4	PIVOT BOLT	SP118
7	4	1/2" -13 LOCK NUT	SP120
8	4	1/2" -13 JAM NUT	SP118
9	4	1/2" SAE WASHER	SP009
10	4	1/2" STD. WASHER	SP121

STD. CUT-THRU = #SW021 ELECTRO-GALV.
ALSO AVAILABLE IN STAINLESS STEEL.

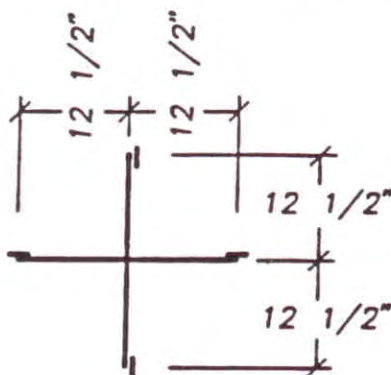

PLAN VIEW

6006 HEAVY DUTY CUT-THRU SWITCH

MAXIMUM LOAD CAPACITY 1,500 LBS

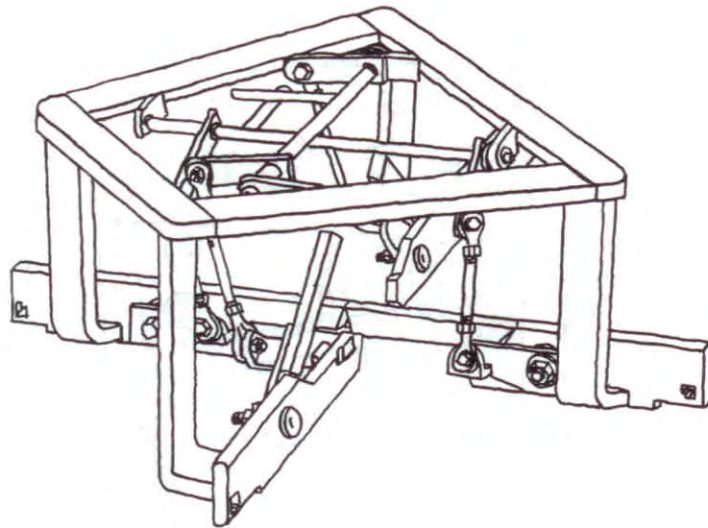

HEAVY DUTY CUT-THRU REPLACEMENT PARTS

PART	PCS	PART DESCRIPTION	SP#
1	4	LIFT TRACK ASSY.	-----
2	4	LIFT LINKS - TIE ROD	-----
ABOVE PARTS MUST BE ORDERED AS A SET			
3	2	OPERATING RODS - TIE ROD	-----
4	4	PIVOT BOLT	SP118
5	4	OPERATING RODS - TIE ROD	-----
6	4	1/2" -13 LOCK NUT	SP120
7	4	1/2" -13 JAM NUT	SP119
8	4	1/2" SAE WASHER	SP009
9	4	1/2" STD. WASHER	SP121
10	8	TIE ROD NUT	RM088

THE ABOVE SWITCH IS ALSO AVAILABLE IN
STAINLESS STEEL.

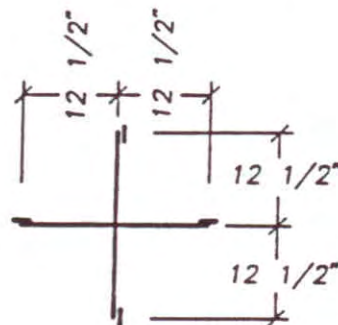

PLAN VIEW

6006 AUTOMATIC CONVEYOR SWITCH

MAXIMUM LOAD CAPACITY 1,500 LBS

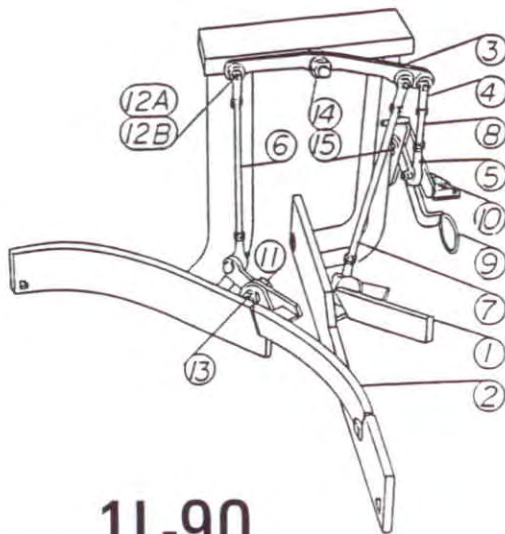

1L-90
REPLACEMENT PARTS *

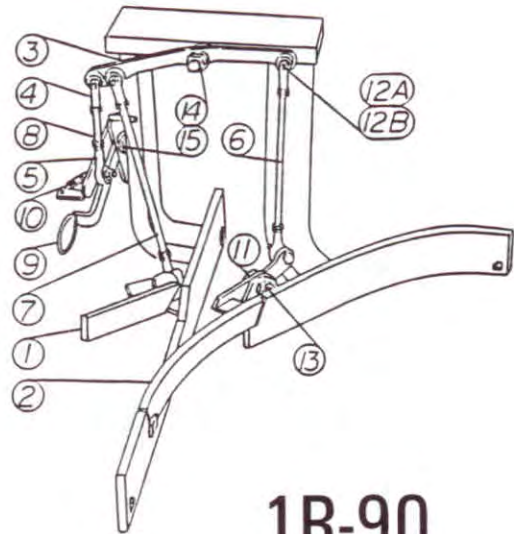

1R-90
REPLACEMENT PARTS *

PART	PCS	PART DESCRIPTION	SP#
1	1	STRAIGHT LIFT TRACK ASSY.	SP086
2	1	CURVED LIFT TRACK ASSY.	SP082
3	1	ROCKER ARM	SP178
4	3	TIE ROD END-RT. HAND THREAD	FG775
5	3	TIE ROD END-LT. HAND THREAD	FG776
6	1	CURVED LIFT ROD*	SP175
7	1	STRAIGHT LIFT ROD*	SP176
8	1	SELECTOR ROD*	SP182
9	1	DIRECTION SELECTOR ASSY.	SP040
10	1	DIRECTION SELECTOR SPRING	FG548
11	2	PIVOT BOLT W/BEARING WASHER	SP186
12a	6	TIE ROD NUT	RM085
12b	12	TIE ROD LOCK WASHER	RM185
13	2	1/2" - 20 LOCK NUT	SP187
14	2	1/2" - 13 LOCK NUT	SP120
15	4	1/2" SAE WASHER	SP009

PART	PCS	PART DESCRIPTION	SP#
1	1	STRAIGHT LIFT TRACK ASSY.	SP085
2	1	CURVED LIFT TRACK ASSY.	SP081
3	1	ROCKER ARM	SP177
4	3	TIE ROD END-RT. HAND THREAD	FG775
5	3	TIE ROD END-LT. HAND THREAD	FG776
6	1	CURVED LIFT ROD*	SP175
7	1	STRAIGHT LIFT ROD*	SP176
8	1	SELECTOR ROD*	SP182
9	1	DIRECTION SELECTOR ASSY.	SP141
10	1	DIRECTION SELECTOR SPRING	FG548
11	2	PIVOT BOLT W/BEARING WASHER	SP186
12a	6	TIE ROD NUT	RM085
12b	12	TIE ROD LOCK WASHER	RM185
13	2	1/2" - 20 LOCK NUT	SP187
14	2	1/2" - 13 LOCK NUT	SP120
15	4	1/2" SAE WASHER	SP009

1L-90 = #SW099 ELECTRO-GALV.
ALSO AVAILABLE IN STAINLESS STEEL.

1R-90 = #SW096 ELECTRO-GALV.
ALSO AVAILABLE IN STAINLESS STEEL.

* FOR STD. 13 1/2" HIGH BRIDGE. FOR DIFFERENT BRIDGE HEIGHTS, LENGTH OF ROD VARIES. PLEASE SPECIFY WHEN ORDERING.

THE ABOVE SWITCHES ARE ALSO AVAILABLE WITH A 45° CURVED TRACK IN LIEU OF A 90° CURVED TRACK. SEE SWITCH OPTIONS LISTED ON PAGE #30.

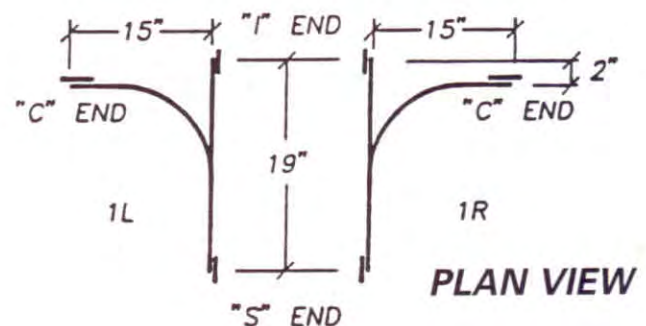

6009 SST AUTOMATIC CONVEYOR SWITCH

MAXIMUM LOAD CAPACITY 1,500 LBS

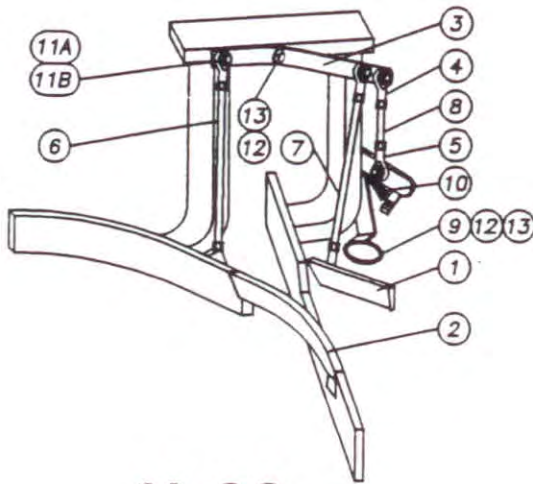

1L-90
REPLACEMENT PARTS *

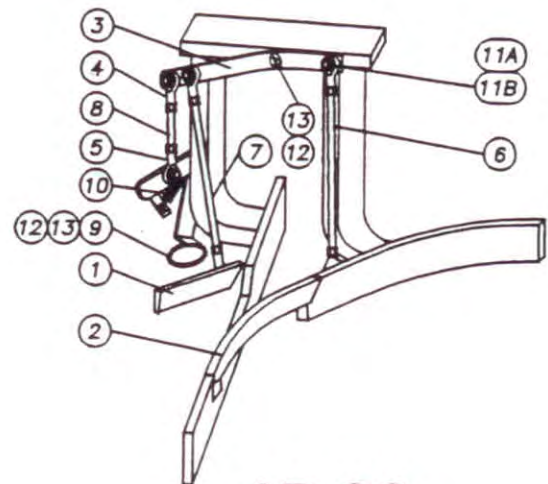

1R-90
REPLACEMENT PARTS *

PART	PCS	PART DESCRIPTION	SP#
1	1	STRAIGHT LIFT TRACK ASSY.	SP286
2	1	CURVED LIFT TRACK ASSY.	SP282
3	1	ROCKER ARM	SP278
4	3	TIE ROD END-RT. HAND THREAD	FG775
5	3	TIE ROD END-LT. HAND THREAD	FG776
6	1	CURVED LIFT ROD*	SP175
7	1	STRAIGHT LIFT ROD*	SP176
8	1	SELECTOR ROD*	SP182
9	1	DIRECTION SELECTOR ASSY.	SP040
10	1	DIRECTION SELECTOR SPRING	FG548
11a	6	TIE ROD NUT	RM085
11b	12	TIE ROD LOCK WASHER	RM185
12	2	1/2" - 13 LOCK NUT	SP120
13	2	1/2" SAE WASHER	SP009

PART	PCS	PART DESCRIPTION	SP#
1	1	STRAIGHT LIFT TRACK ASSY.	SP285
2	1	CURVED LIFT TRACK ASSY.	SP281
3	1	ROCKER ARM	SP277
4	3	TIE ROD END-RT. HAND THREAD	FG775
5	3	TIE ROD END-LT. HAND THREAD	FG776
6	1	CURVED LIFT ROD*	SP175
7	1	STRAIGHT LIFT ROD*	SP176
8	1	SELECTOR ROD*	SP182
9	1	DIRECTION SELECTOR ASSY.	SP141
10	1	DIRECTION SELECTOR SPRING	FG548
11a	6	TIE ROD NUT	RM085
11b	12	TIE ROD LOCK WASHER	RM185
12	2	1/2" - 13 LOCK NUT	SP120
13	2	1/2" SAE WASHER	SP009

1L-90 = #SW099 ELECTRO-GALV.
ALSO AVAILABLE IN STAINLESS STEEL.

1R-90 = #SW096 ELECTRO-GALV.
ALSO AVAILABLE IN STAINLESS STEEL.

* FOR STD. 13 1/2" HIGH BRIDGE. FOR DIFFERENT BRIDGE HEIGHTS, LENGTH OF ROD VARIES. PLEASE SPECIFY WHEN ORDERING.

THE ABOVE SWITCHES ARE ALSO AVAILABLE WITH A 45° CURVED TRACK IN LIEU OF A 90° CURVED TRACK. SEE SWITCH OPTIONS LISTED ON PAGE #30.

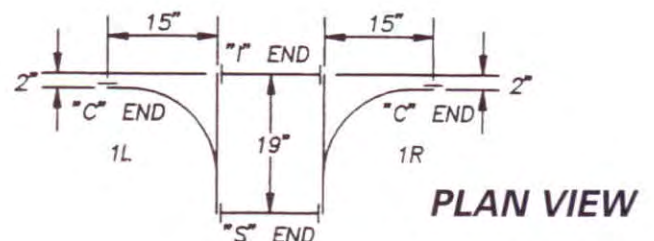

6006 AUTOMATIC CONVEYOR SWITCH

MAXIMUM LOAD CAPACITY 1,500 LBS

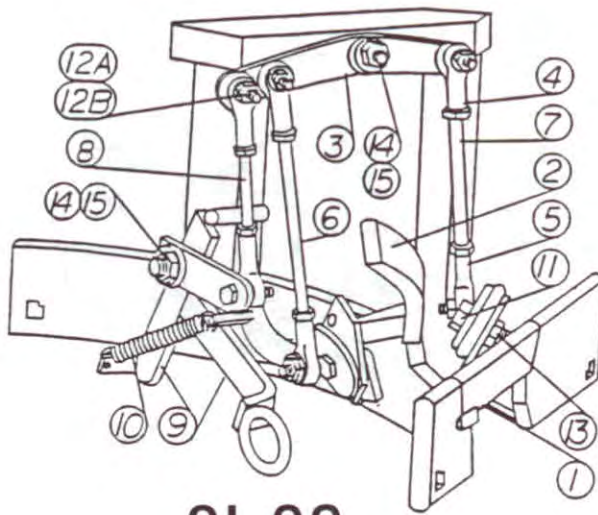

2L-90
REPLACEMENT PARTS *

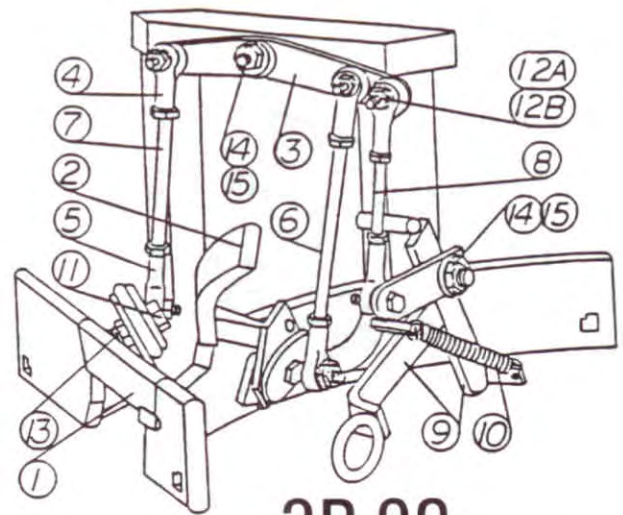

2R-90
REPLACEMENT PARTS *

PART	PCS	PART DESCRIPTION	SP#
1	1	STRAIGHT LIFT TRACK ASSY.	SP088
2	1	CURVED LIFT TRACK ASSY.	SP084
3	1	ROCKER ARM	SP171
4	3	TIE ROD END-RT. HAND THREAD	FG775
5	3	TIE ROD END-LT. HAND THREAD	FG776
6	1	CURVED LIFT ROD*	SP173
7	1	STRAIGHT LIFT ROD*	SP174
8	1	SELECTOR ROD*	SP182
9	1	DIRECTION SELECTOR ASSY.	SP141
10	1	DIRECTION SELECTOR SPRING	FG548
11	2	PIV. BOLT W/BEARING WASHER	SP186
12a	6	TIE ROD NUT	RM085
12b	12	TIE ROD LOCK WASHER	RM145
13	2	1/2" - 20 LOCK WASHER	SP187
14	2	1/2" - 13 LOCK NUT	SP120
15	4	1/2" SAE WASHER	SP009

PART	PCS	PART DESCRIPTION	SP#
1	1	STRAIGHT LIFT TRACK ASSY.	SP087
2	1	CURVED LIFT TRACK ASSY.	SP083
3	1	ROCKER ARM	SP172
4	3	TIE ROD END-RT. HAND THREAD	FG775
5	3	TIE ROD END-LT. HAND THREAD	FG776
6	1	CURVED LIFT ROD*	SP173
7	1	STRAIGHT LIFT ROD*	SP174
8	1	SELECTOR ROD*	SP182
9	1	DIRECTION SELECTOR ASSY.	SP040
10	1	DIRECTION SELECTOR SPRING	FG548
11	2	PIV. BOLT W/BEARING WASHER	SP186
12a	6	TIE ROD NUT	RM085
12b	12	TIE ROD LOCK WASHER	RM145
13	2	1/2" - 20 LOCK WASHER	SP187
14	2	1/2" - 13 LOCK NUT	SP120
15	4	1/2" SAE WASHER	SP009

2L-90 = #SW100 ELECTRO-GALV.
ALSO AVAILABLE IN STAINLESS STEEL.

2R-90 = #SW097 ELECTRO-GALV.
ALSO AVAILABLE IN STAINLESS STEEL.

* FOR STD. 13 1/2" HIGH BRIDGE. FOR DIFFERENT BRIDGE HEIGHTS, LENGTH OF ROD VARIES. PLEASE SPECIFY WHEN ORDERING.

THE ABOVE SWITCHES ARE ALSO AVAILABLE WITH A 45° CURVED TRACK IN LIEU OF A 90° CURVED TRACK. SEE SWITCH OPTIONS LISTED ON PAGE #30.

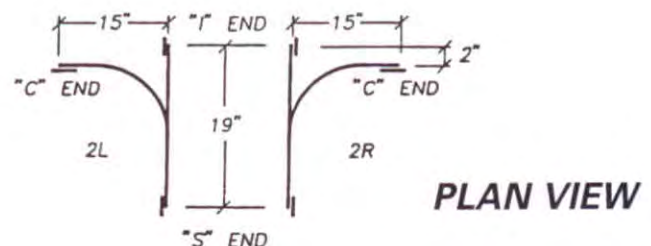

PLAN VIEW

6009 SST AUTOMATIC CONVEYOR SWITCH

MAXIMUM LOAD CAPACITY 1,500 LBS

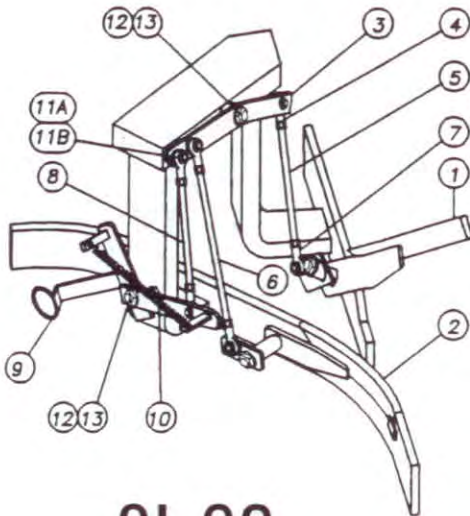

2L-90
REPLACEMENT PARTS

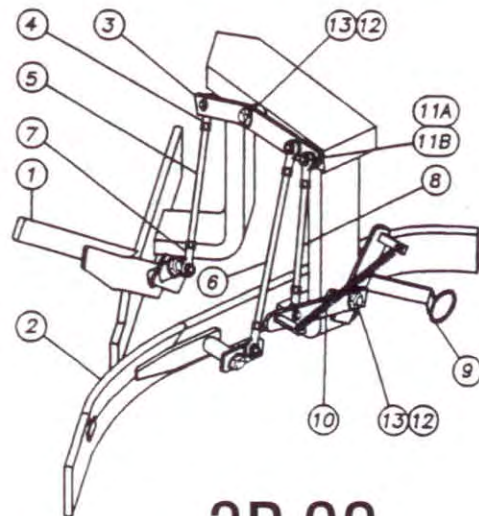

2R-90
REPLACEMENT PARTS

PART	PCS	PART DESCRIPTION	SP#
1	1	STRAIGHT LIFT TRACK ASSY.	SP288
2	1	CURVED LIFT TRACK ASSY.	SP284
3	1	ROCKER ARM	SP272
4	3	TIE ROD END-RT. HAND THREAD	FG775
5	3	TIE ROD END-LT. HAND THREAD	FG776
6	1	CURVED LIFT ROD*	SP173
7	1	STRAIGHT LIFT ROD*	SP174
8	1	SELECTOR ROD	SP182
9	1	DIRECTION SELECTOR ASSY.	SP141
10	1	DIRECTION SELECTOR SPRING	FG548
11a	6	TIE ROD NUT	RM085
11b	12	TIE ROD LOCK WASHER	RM145
12	2	1/2" - 13 LOCK NUT	SP120
13	2	1/2" SAE WASHER	SP009

2L-90 = #SW100 ELECTRO-GALV.
ALSO AVAILABLE IN STAINLESS STEEL.

PART	PCS	PART DESCRIPTION	SP#
1	1	STRAIGHT LIFT TRACK ASSY.	SP287
2	1	CURVED LIFT TRACK ASSY.	SP283
3	1	ROCKER ARM	SP271
4	3	TIE ROD END-RT. HAND THREAD	FG775
5	3	TIE ROD END-LT. HAND THREAD	FG776
6	1	CURVED LIFT ROD*	SP173
7	1	STRAIGHT LIFT ROD*	SP174
8	1	SELECTOR ROD*	SP182
9	1	DIRECTION SELECTOR ASSY.	SP040
10	1	DIRECTION SELECTOR SPRING	FG548
11a	6	TIE ROD NUT	RM085
11b	12	TIE ROD LOCK WASHER	RM145
12	2	1/2" - 13 LOCK NUT	SP120
13	2	1/2" SAE WASHER	SP009

2R-90 = #SW097 ELECTRO-GALV.
ALSO AVAILABLE IN STAINLESS STEEL.

* FOR STD. 13 1/2" HIGH BRIDGE. FOR DIFFERENT BRIDGE HEIGHTS, LENGTH OF ROD VARIES. PLEASE SPECIFY WHEN ORDERING.

THE ABOVE SWITCHES ARE ALSO AVAILABLE WITH A 45° CURVED TRACK IN LIEU OF A 90° CURVED TRACK. SEE SWITCH OPTIONS LISTED ON PAGE #30.

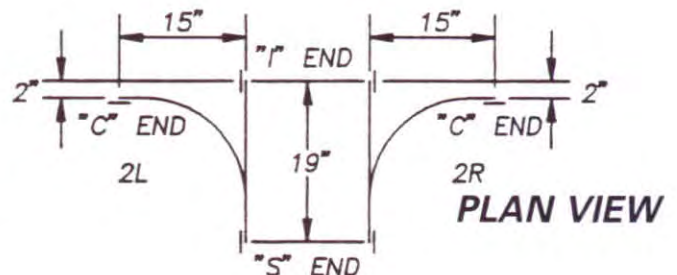

6007 STANDARD GEAR OPERATED SWITCH

MAXIMUM LOAD CAPACITY 500 LBS

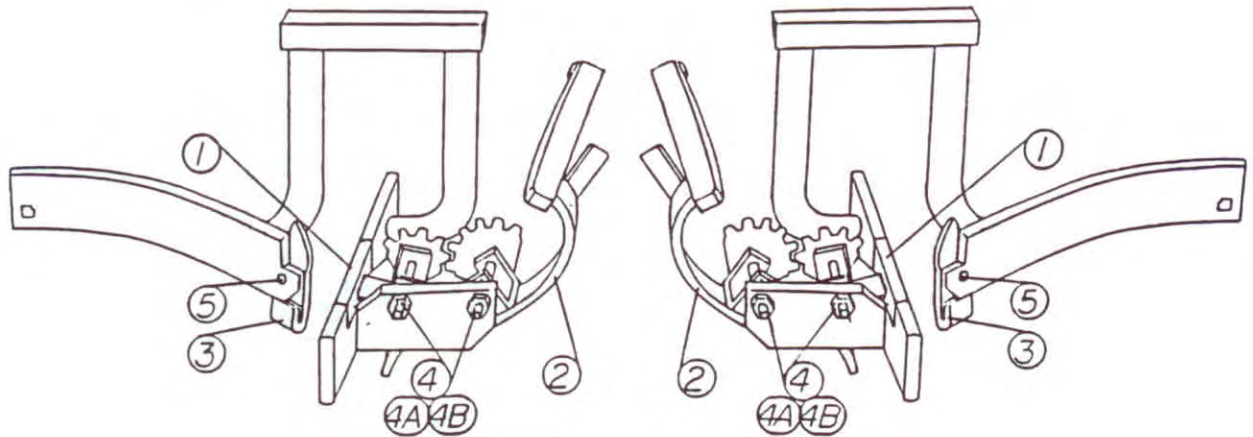

1L-90 REPLACEMENT PARTS

PART	PCS	PART DESCRIPTION	SP#
1	1	STRAIGHT LIFT TRACK ASSY.	SP132
2	1	CURVED LIFT TRACK ASSY.	SP136
3	1	TROLLEY STOP	SP122
4	2	3/8" HINGE BOLT	SP138
4a	2	3/8" HINGE BOLT WASHER	SP139
4b	2	3/8" HINGE BOLT NUT	SP140
5	1	1" FLAT HEAD RIVET	SP179

1L-90 = #SW044 ELECTRO-GALV.
ALSO AVAILABLE IN STAINLESS STEEL.

1R-90 REPLACEMENT PARTS

PART	PCS	PART DESCRIPTION	SP#
1	1	STRAIGHT LIFT TRACK ASSY.	SP133
2	1	CURVED LIFT TRACK ASSY.	SP137
3	1	TROLLEY STOP	SP053
4	2	3/8" HINGE BOLT	SP138
4a	2	3/8" HINGE BOLT WASHER	SP139
4b	2	3/8" HINGE BOLT NUT	SP140
5	1	1" FLAT HEAD RIVET	SP179

1R-90 = #SW046 ELECTRO-GALV.
ALSO AVAILABLE IN STAINLESS STEEL.

THE ABOVE SWITCHES ARE ALSO AVAILABLE WITH A 45° CURVED TRACK IN LIEU OF A 90° CURVED TRACK. SEE SWITCH OPTIONS LISTED ON PAGE #30.

1L-45 = #SW043 ELECTRO-GALV.

1R-45 = #SW045 ELECTRO-GALV.

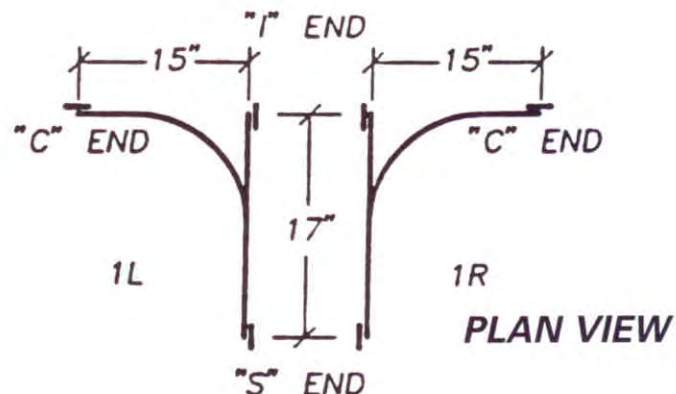

6007 STANDARD GEAR OPERATED SWITCH

MAXIMUM LOAD CAPACITY 500 LBS

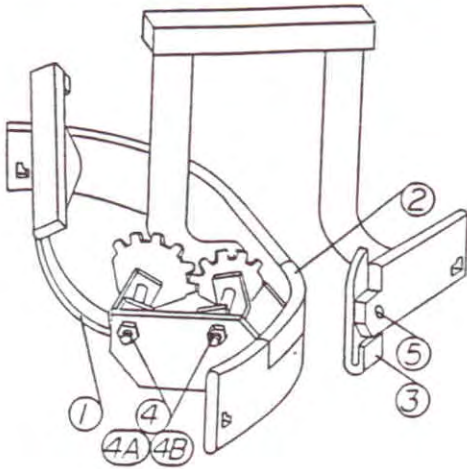

2L-90 REPLACEMENT PARTS

PART	PCS	PART DESCRIPTION	SP#
1	1	STRAIGHT LIFT TRACK ASSY.	SP134
2	1	CURVED LIFT TRACK ASSY.	SP130
3	1	TROLLEY STOP	SP053
4	2	3/8" HINGE BOLT	SP138
4a	2	3/8" HINGE BOLT WASHER	SP139
4b	2	3/8" HINGE BOLT NUT	SP140
5	1	1" FLAT HEAD RIVET	SP179

2L-90 = #SW048 ELECTRO-GALV.
ALSO AVAILABLE IN STAINLESS STEEL.

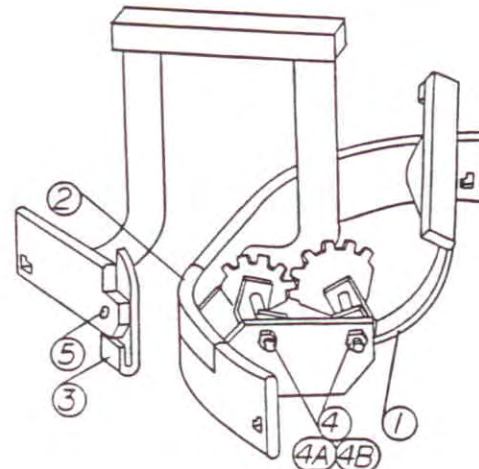

2R-90 REPLACEMENT PARTS

PART	PCS	PART DESCRIPTION	SP#
1	1	STRAIGHT LIFT TRACK ASSY.	SP135
2	1	CURVED LIFT TRACK ASSY.	SP131
3	1	TROLLEY STOP	SP122
4	2	3/8" HINGE BOLT	SP138
4a	2	3/8" HINGE BOLT WASHER	SP139
4b	2	3/8" HINGE BOLT NUT	SP140
5	1	1" FLAT HEAD RIVET	SP179

2R-90 = #SW050 ELECTRO-GALV.
ALSO AVAILABLE IN STAINLESS STEEL.

THE ABOVE SWITCHES ARE ALSO AVAILABLE WITH A 45° CURVED TRACK IN LIEU OR A 90° CURVED TRACK. SEE SWITCH OPTIONS LISTED ON PAGE #30.

2L-45 = #SW047 ELECTRO-GALV.

2R-45 = #5W049 ELECTRO-GALV

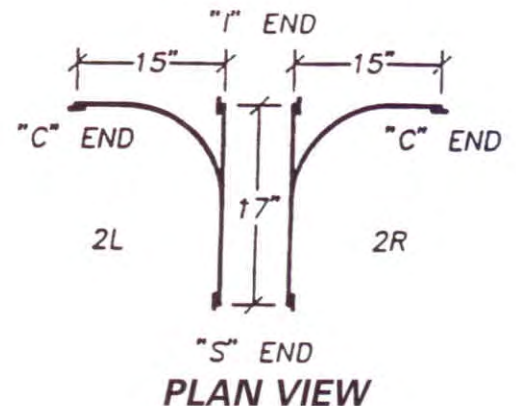

6007 STANDARD GEAR OPERATED SWITCH

MAXIMUM LOAD CAPACITY 500 LBS

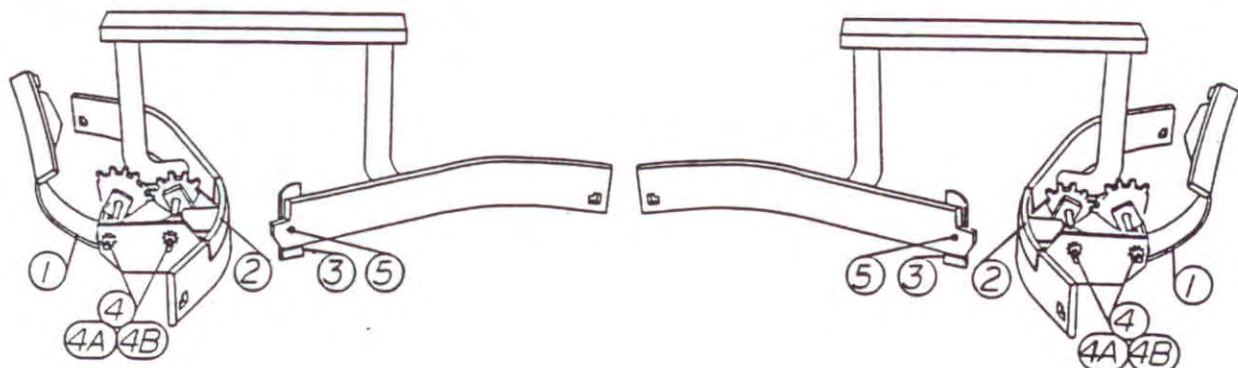

3L-90 REPLACEMENT PARTS

PART	PCS	PART DESCRIPTION	SP#
1	1	RIGHT CURVE LIFT ASSY.	-----
2	1	LEFT CURVE LIFT ASSY.	SP130
3	1	TROLLEY STOP	SP053
4	2	3/8" HINGE BOLT	SP138
4a	2	3/8" HINGE BOLT WASHER	SP139
4b	2	3/8" HINGE BOLT NUT	SP140
5	1	1" FLAT HEAD RIVET	SP179

3L-90 = #SW040 ELECTRO-GALV.
ALSO AVAILABLE IN STAINLESS STEEL.

3R-90 REPLACEMENT PARTS

PART	PCS	PART DESCRIPTION	SP#
1	1	LEFT CURVE LIFT ASSY.	-----
2	1	RIGHT CURVE LIFT ASSY.	SP131
3	1	TROLLEY STOP	SP122
4	2	3/8" HINGE BOLT	SP138
4a	2	3/8" HINGE BOLT WASHER	SP139
4b	2	3/8" HINGE BOLT NUT	SP140
5	1	1" FLAT HEAD RIVET	SP179

3R-90 = #SW042 ELECTRO-GALV.
ALSO AVAILABLE IN STAINLESS STEEL.

THE ABOVE SWITCHES ARE ALSO AVAILABLE WITH A 45° CURVED TRACK IN LIEU OF A 90° CURVED TRACK. SEE SWITCH OPTIONS LISTED ON PAGE #30.

3L-45 = #SW039 ELECTRO-GALV.

3R-45 = #5W041 ELECTRO-GALV

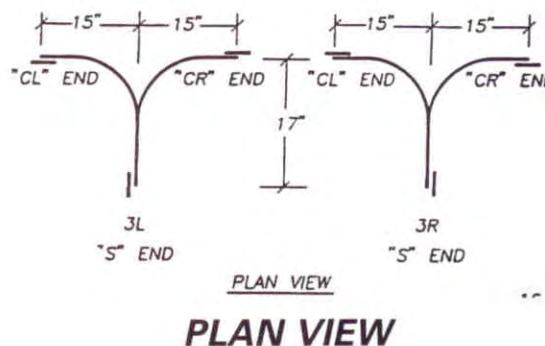

6007 GEAR CONVEYOR SWITCH

MAXIMUM LOAD CAPACITY 1,500 LBS

LEFIELL DOES NOT RECOMMEND THIS SWITCH FOR CONVEYORIZED SYSTEMS.

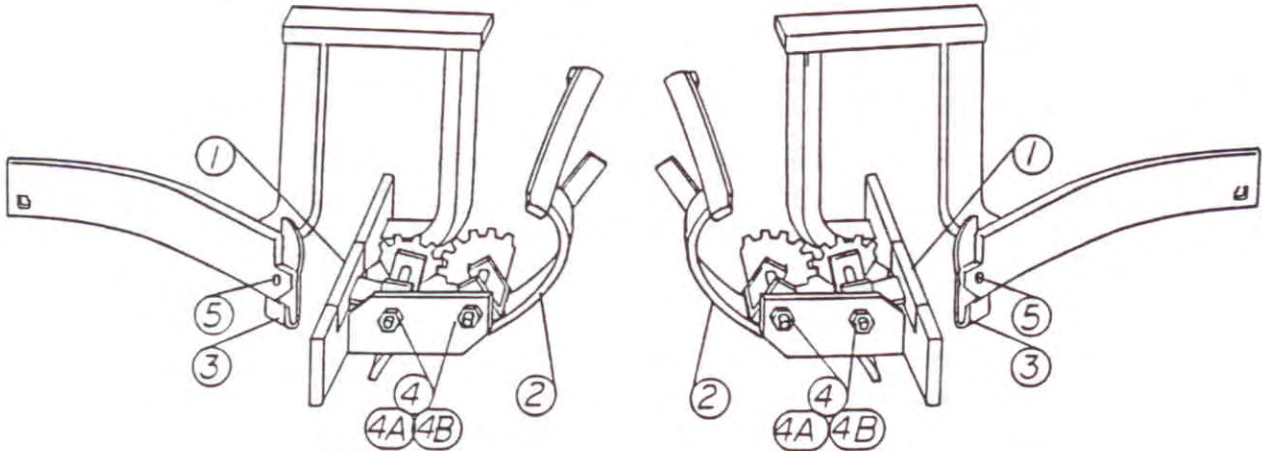

1L-90 REPLACEMENT PARTS

PART	PCS	PART DESCRIPTION	SP#
1	1	STRAIGHT LIFT TRACK ASSY.	SP132
2	1	CURVED LIFT TRACK ASSY.	SP136
3	1	TROLLEY STOP	SP122
4	2	3/8" HINGE BOLT	SP138
4a	2	3/8" HINGE BOLT WASHER	SP139
4b	2	3/8" HINGE BOLT NUT	SP140
5	1	1" FLAT HEAD RIVET	SP179

1L-90 = #SW052 ELECTRO-GALV.
ALSO AVAILABLE IN STAINLESS STEEL.

(13 1/2" BRIDGE HEIGHT)

1R-90 REPLACEMENT PARTS

PART	PCS	PART DESCRIPTION	SP#
1	1	STRAIGHT LIFT TRACK ASSY.	SP133
2	1	CURVED LIFT TRACK ASSY.	SP137
3	1	TROLLEY STOP	SP122
4	2	3/8" HINGE BOLT	SP138
4a	2	3/8" HINGE BOLT WASHER	SP139
4b	2	3/8" HINGE BOLT NUT	SP140
5	1	1" FLAT HEAD RIVET	SP179

1R-90 = #SW054 ELECTRO-GALV.
ALSO AVAILABLE IN STAINLESS STEEL.

(13 1/2" BRIDGE HEIGHT)

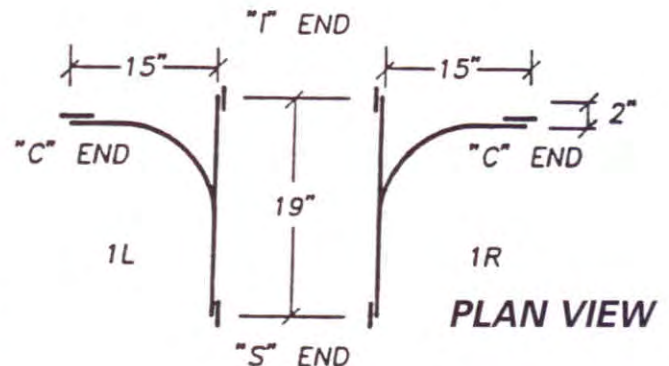

THE ABOVE SWITCHES ARE ALSO AVAILABLE WITH A 45° CURVED TRACK IN LIEU OR A 90° CURVED TRACK. SEE SWITCH OPTIONS LISTED ON PAGE #30.

6007 GEAR CONVEYOR SWITCH

MAXIMUM LOAD CAPACITY 1,500 LBS

LEFIELL DOES NOT RECOMMEND THIS SWITCH FOR CONVEYORIZED SYSTEMS.

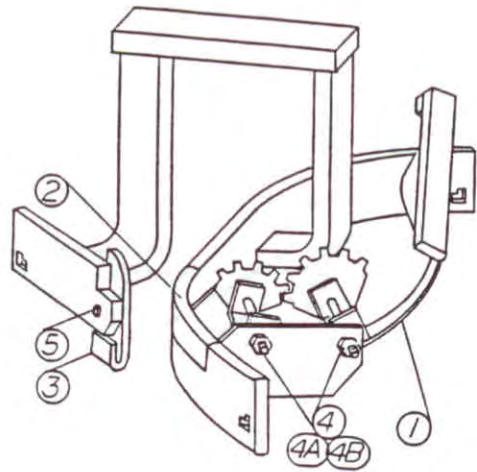
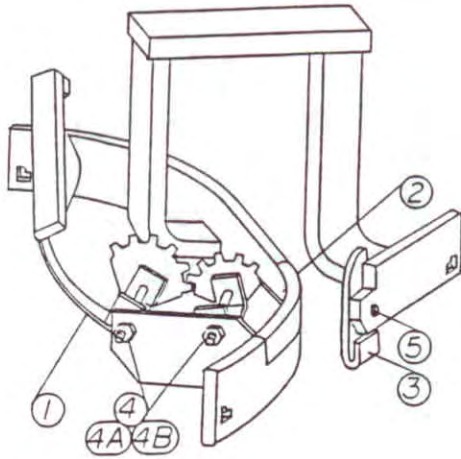

2L-90 REPLACEMENT PARTS

PART	PCS	PART DESCRIPTION	SP#
1	1	STRAIGHT LIFT TRACK ASSY.	SP134
2	1	CURVED LIFT TRACK ASSY.	SP130
3	1	TROLLEY STOP	SP053
4	2	3/8" HINGE BOLT	SP138
4a	2	3/8" HINGE BOLT WASHER	SP139
4b	2	3/8" HINGE BOLT NUT	SP140
5	1	1" FLAT HEAD RIVET	SP179

2L-90 = #SW055 ELECTRO-GALV.
ALSO AVAILABLE IN STAINLESS STEEL.

2R-90 REPLACEMENT PARTS

PART	PCS	PART DESCRIPTION	SP#
1	1	STRAIGHT LIFT TRACK ASSY.	SP135
2	1	CURVED LIFT TRACK ASSY.	SP131
3	1	TROLLEY STOP	SP122
4	2	3/8" HINGE BOLT	SP138
4a	2	3/8" HINGE BOLT WASHER	SP139
4b	2	3/8" HINGE BOLT NUT	SP140
5	1	1" FLAT HEAD RIVET	SP179

2R-90 = #SW056 ELECTRO-GALV.
ALSO AVAILABLE IN STAINLESS STEEL.

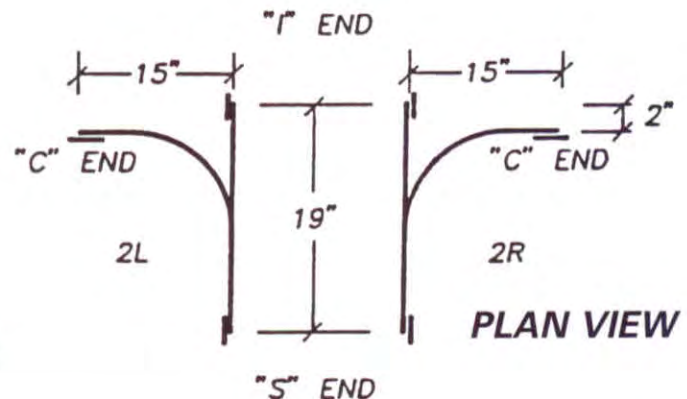

THE ABOVE SWITCHES ARE ALSO AVAILABLE WITH A 45° CURVED TRACK IN LIEU OR A 90° CURVED TRACK. SEE SWITCH OPTIONS LISTED ON PAGE #30.

6008 GEAR BLEED RAIL SWITCH

MAXIMUM LOAD CAPACITY 3,000 LBS

(EXTRA HEAVY DUTY)

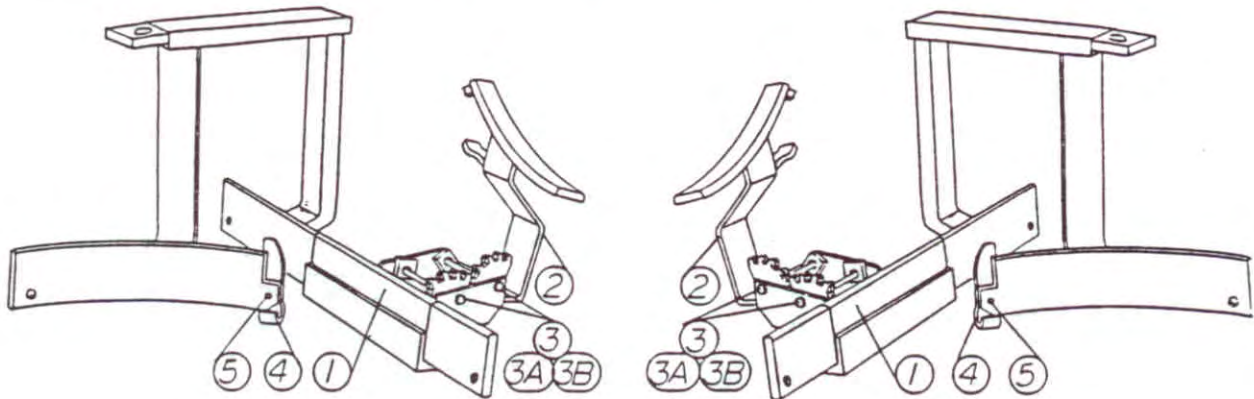

1L-90 REPLACEMENT PARTS

PART	PCS	PART DESCRIPTION	SP#
1	1	STRAIGHT LIFT TRACK ASSY.	-----
2	1	CURVED LIFT TRACK ASSY.	-----
3	1	3/8" HINGE BOLT	SP138
3a	2	3/8" HINGE BOLT WASHER	SP139
3b	2	3/8" HINGE BOLT NUT	SP140
4	1	TROLLEY STOP	SP170
5	1	1" FLAT HEAD RIVET	SP179

1L-90 = #SW057 ELECTRO-GALV.
ALSO AVAILABLE IN STAINLESS STEEL.

1R-90 REPLACEMENT PARTS

PART	PCS	PART DESCRIPTION	SP#
1	1	STRAIGHT LIFT TRACK ASSY.	-----
2	1	CURVED LIFT TRACK ASSY.	-----
3	1	3/8" HINGE BOLT	SP138
3a	2	3/8" HINGE BOLT WASHER	SP139
3b	2	3/8" HINGE BOLT NUT	SP140
4	1	TROLLEY STOP	SP170
5	1	1" FLAT HEAD RIVET	SP179

1R-90 = #SW058 ELECTRO-GALV.
ALSO AVAILABLE IN STAINLESS STEEL.

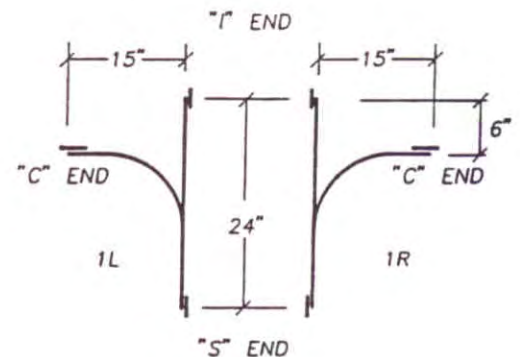

THE ABOVE SWITCHES ARE ALSO AVAILABLE WITH A 45° CURVED TRACK IN LIEU OF A 90° CURVED TRACK. SEE SWITCH OPTIONS LISTED ON PAGE #30.

FOR 6008 EXTRA HEAVY DUTY SWITCHES, BRIDGE MUST BE WELDED OR BOLTED FOR MAXIMUM CAPACITY.

PLAN VIEW

6008 GEAR BLEED RAIL SWITCH

MAXIMUM LOAD CAPACITY 3,000 LBS

(EXTRA HEAVY DUTY)

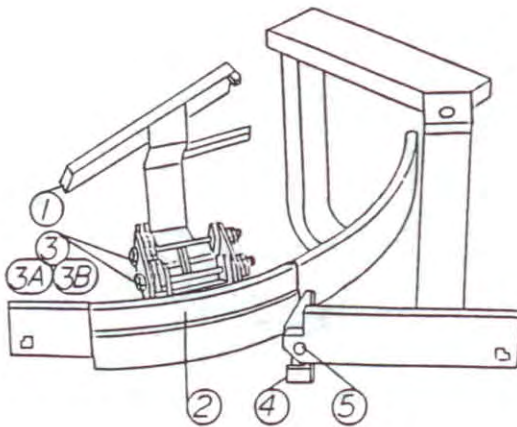

2L-90 REPLACEMENT PARTS

PART	PCS	PART DESCRIPTION	SP#
1	1	STRAIGHT LIFT TRACK ASSY.	-----
2	1	CURVED LIFT TRACK ASSY.	-----
3	1	3/8" HINGE BOLT	SP138
3a	2	3/8" HINGE BOLT WASHER	SP139
3b	2	3/8" HINGE BOLT NUT	SP140
4	1	TROLLEY STOP	SP170
5	1	1" FLAT HEAD RIVET	SP179

2L-90 = #SW057 ELECTRO-GALV.
ALSO AVAILABLE IN STAINLESS STEEL.

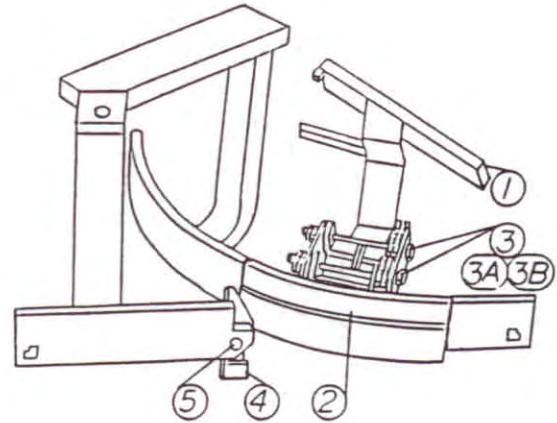

2R-90 REPLACEMENT PARTS

PART	PCS	PART DESCRIPTION	SP#
1	1	STRAIGHT LIFT TRACK ASSY.	-----
2	1	CURVED LIFT TRACK ASSY.	-----
3	1	3/8" HINGE BOLT	SP138
3a	2	3/8" HINGE BOLT WASHER	SP139
3b	2	3/8" HINGE BOLT NUT	SP140
4	1	TROLLEY STOP	SP170
5	1	1" FLAT HEAD RIVET	SP179

2R-90 = #SW060 ELECTRO-GALV.
ALSO AVAILABLE IN STAINLESS STEEL.

THE ABOVE SWITCHES ARE ALSO AVAILABLE WITH A 45° CURVED TRACK IN LIEU OF A 90° CURVED TRACK. SEE SWITCH OPTIONS LISTED ON PAGE #30.

FOR 6008 EXTRA HEAVY DUTY SWITCHES, BRIDGE MUST BE WELDED OR BOLTED FOR MAXIMUM CAPACITY.

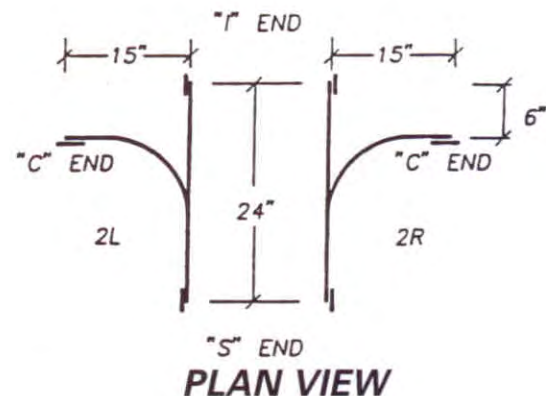

6008 AUTO BLEED RAIL SWITCH

MAXIMUM LOAD CAPACITY 3,000 LBS

(EXTRA HEAVY DUTY)

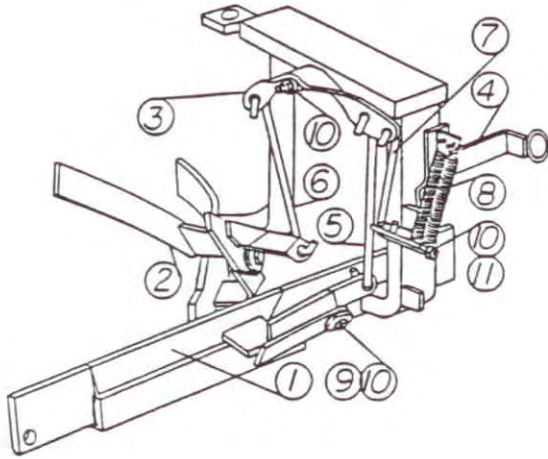

1L-90 REPLACEMENT PARTS

PART	PCS	PART DESCRIPTION	SP#
1	1	STRAIGHT LIFT TRACK ASSY.	-----
2	1	CURVED LIFT TRACK ASSY.	-----
3	1	ROCKER ARM	-----
4	1	DIRECTION SELECTOR ASSY.	-----
5	1	STRAIGHT TRACK LIFT LINK	-----
6	1	CURVED TRACK LIFT LINK	-----
7	1	SELECTOR LIFT LINK	-----
8	2	DIRECTION SELECTOR SPRINGS	FG548
9	2	LIFT TRACK PIV. BOLT ASSY.	-----
10	6	1/2" X 13 LOCK NUT	SP120
11	3	1/2" SAE WASHER	SP009

1L-90 = #SW057 ELECTRO-GALV.
ALSO AVAILABLE IN STAINLESS STEEL.

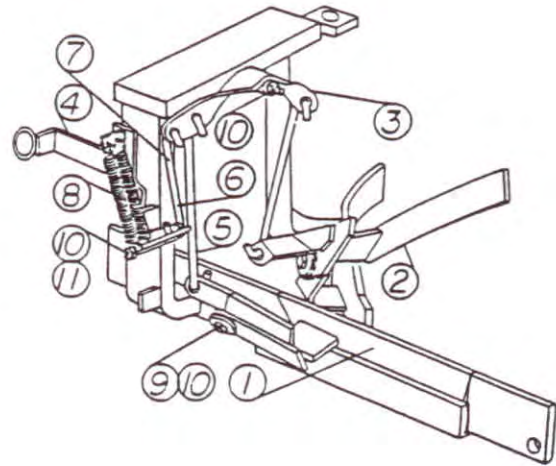

1R-90 REPLACEMENT PARTS

PART	PCS	PART DESCRIPTION	SP#
1	1	STRAIGHT LIFT TRACK ASSY.	-----
2	1	CURVED LIFT TRACK ASSY.	-----
3	1	ROCKER ARM	-----
4	1	DIRECTION SELECTOR ASSY.	-----
5	1	STRAIGHT TRACK LIFT LINK	-----
6	1	CURVED TRACK LIFT LINK	-----
7	1	SELECTOR LIFT LINK	-----
8	2	DIRECTION SELECTOR SPRINGS	FG548
9	2	LIFT TRACK PIV. BOLT ASSY.	-----
10	6	1/2" X 13 LOCK NUT	SP120
11	3	1/2" SAE WASHER	SP009

1R-90 = #SW058 ELECTRO-GALV.
ALSO AVAILABLE IN STAINLESS STEEL.

THE ABOVE SWITCHES ARE ALSO AVAILABLE WITH A 45° CURVED TRACK IN LIEU OF A 90° CURVED TRACK. SEE SWITCH OPTIONS LISTED ON PAGE #30.

FOR 6008 EXTRA HEAVY DUTY SWITCHES, BRIDGE MUST BE WELDED OR BOLTED FOR MAXIMUM CAPACITY.

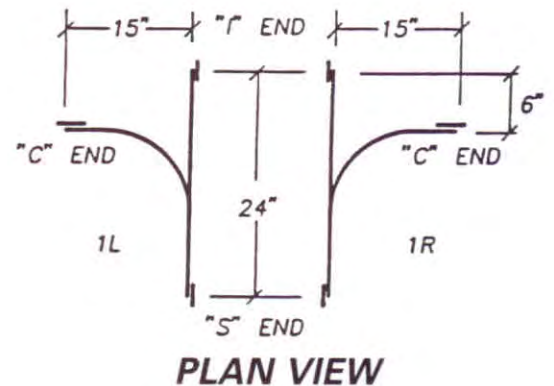

6008 AUTO BLEED RAIL SWITCH

MAXIMUM LOAD CAPACITY 3,000 LBS

(EXTRA HEAVY DUTY)

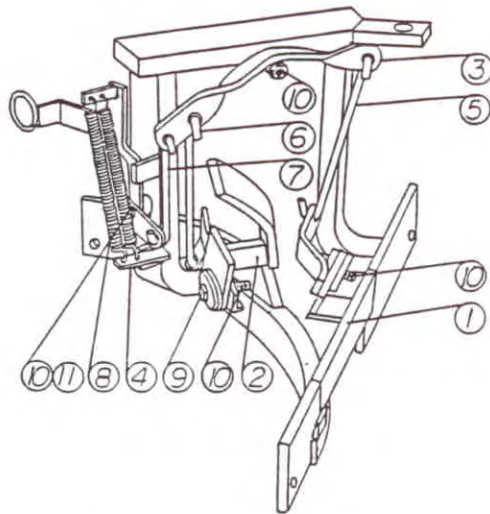

2L-90

REPLACEMENT PARTS

PART	PCS	PART DESCRIPTION	SP#
1	1	STRAIGHT LIFT TRACK ASSY.	-----
2	1	CURVED LIFT TRACK ASSY.	-----
3	1	ROCKER ARM	-----
4	1	DIRECTION SELECTOR ASSY.	-----
5	1	STRAIGHT TRACK LIFT LINK	-----
6	1	CURVED TRACK LIFT LINK	-----
7	1	SELECTOR LIFT LINK	-----
8	2	DIRECTION SELECTOR SPRINGS	FG548
9	2	LIFT TRACK PIV. BOLT ASSY.	-----
10	6	1/2" X 13 LOCK NUT	SP120
11	3	1/2" SAE WASHER	SP009

2L-90 = #SW063 ELECTRO-GALV.
ALSO AVAILABLE IN STAINLESS STEEL.

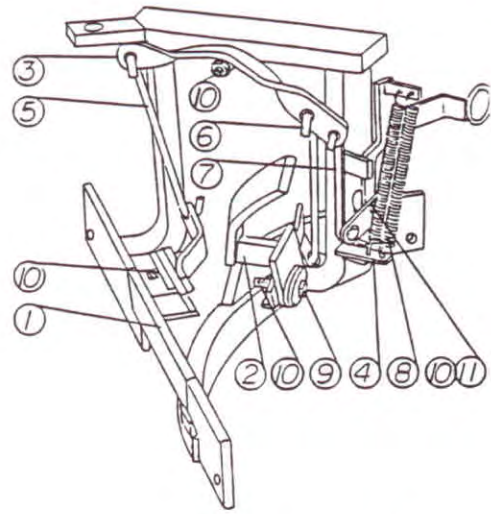

2R-90

REPLACEMENT PARTS

PART	PCS	PART DESCRIPTION	SP#
1	1	STRAIGHT LIFT TRACK ASSY.	-----
2	1	CURVED LIFT TRACK ASSY.	-----
3	1	ROCKER ARM	-----
4	1	DIRECTION SELECTOR ASSY.	-----
5	1	STRAIGHT TRACK LIFT LINK	-----
6	1	CURVED TRACK LIFT LINK	-----
7	1	SELECTOR LIFT LINK	-----
8	2	DIRECTION SELECTOR SPRINGS	FG548
9	2	LIFT TRACK PIV. BOLT ASSY.	-----
10	6	1/2" X 13 LOCK NUT	SP120
11	3	1/2" SAE WASHER	SP009

2R-90 = #SW064 ELECTRO-GALV.
ALSO AVAILABLE IN STAINLESS STEEL.

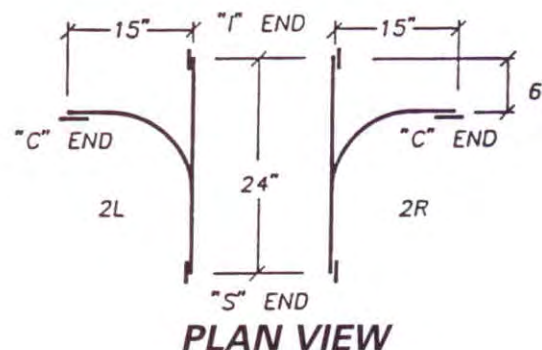

THE ABOVE SWITCHES ARE ALSO AVAILABLE WITH A 45° CURVED TRACK IN LIEU OF A 90° CURVED TRACK. SEE SWITCH OPTIONS LISTED ON PAGE #30.

FOR 6008 EXTRA HEAVY DUTY SWITCHES, BRIDGE MUST BE WELDED OR BOLTED FOR MAXIMUM CAPACITY.

6010 2ND LEG TRANSFER SWITCH

MAXIMUM LOAD CAPACITY 1,500 LBS

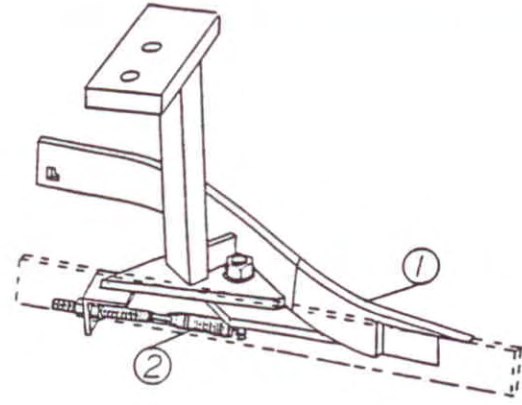
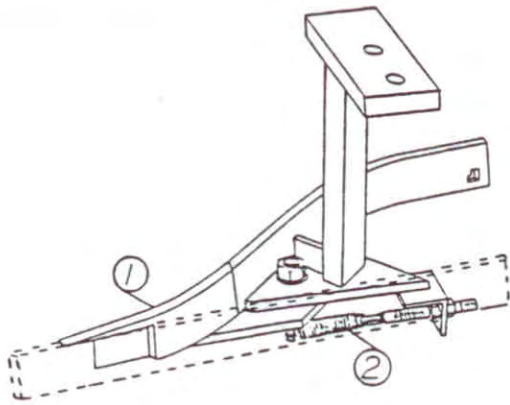

1L REPLACEMENT PARTS

PART	PCS	PART DESCRIPTION	SP#
1	1	MOVEABLE TRACK ASSY.	-----
-	-	INCL. BOLT, NUT & BUSHING	-----
2	1	SPRING	FG538

1L = #SW065 ELECTRO-GALV.
ALSO AVAILABLE IN STAINLESS STEEL.

1R REPLACEMENT PARTS

PART	PCS	PART DESCRIPTION	SP#
1	1	MOVEABLE TRACK ASSY.	-----
-	-	INCL. BOLT, NUT & BUSHING	-----
2	1	SPRING	FG538

1R = #SW066 ELECTRO-GALV.
ALSO AVAILABLE IN STAINLESS STEEL.

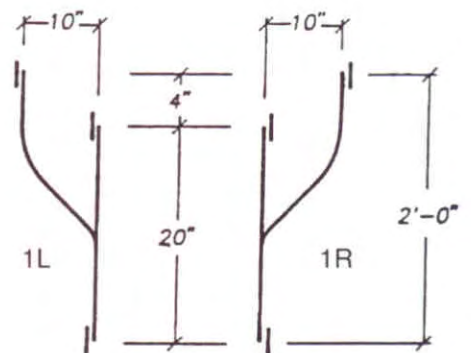

PLAN VIEW

6010 2ND LEG TRANSFER SWITCH

MAXIMUM LOAD CAPACITY 1,500 LBS

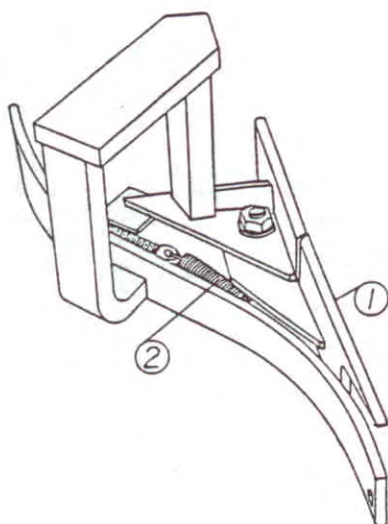

2L REPLACEMENT PARTS

PART	PCS	PART DESCRIPTION	SP#
1	1	MOVEABLE TRACK ASSY.	-----
-	-	INCL. BOLT, NUT & BUSHING	-----
2	1	SPRING	FG538

2L = #SW065 ELECTRO-GALV.
ALSO AVAILABLE IN STAINLESS STEEL.

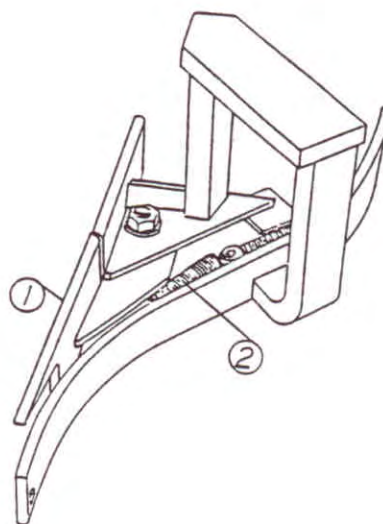

2R REPLACEMENT PARTS

PART	PCS	PART DESCRIPTION	SP#
1	1	MOVEABLE TRACK ASSY.	-----
-	-	INCL. BOLT, NUT & BUSHING	-----
2	1	SPRING	FG538

2R = #SW068 ELECTRO-GALV.
ALSO AVAILABLE IN STAINLESS STEEL.

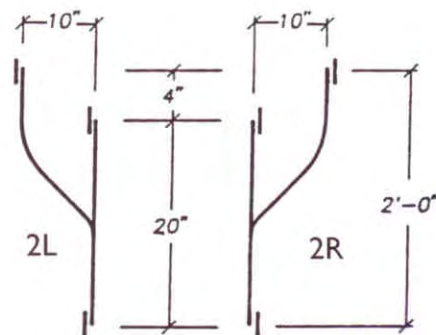

PLAN VIEW

6011 LIFT & TURN SWITCH

MAXIMUM LOAD CAPACITY 1,500 LBS

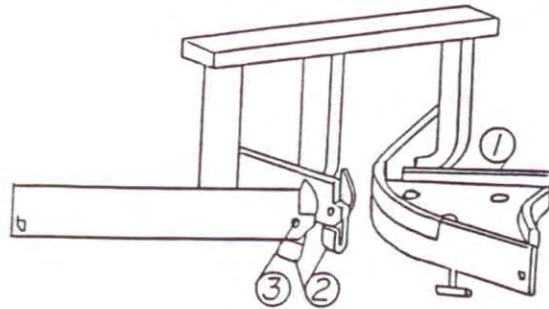
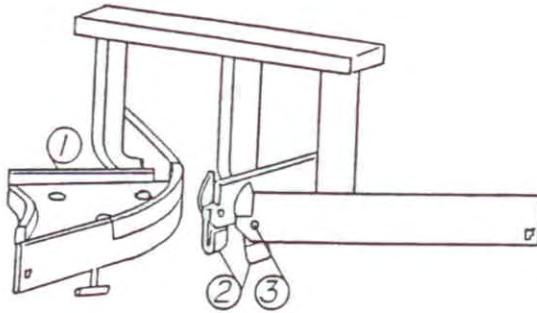

TTL

REPLACEMENT PARTS

PART	PCS	PART DESCRIPTION	SP#
1	1	LIFT & TURN PLATE	-----
2	2	TROLLEY STOP	SP053
3	2	1" FLAT HEAD RIVET	SP179

TTL = #SW019 ELECTRO-GALV.)
ALSO AVAILABLE IN STAINLESS STEEL.

TTR

REPLACEMENT PARTS

PART	PCS	PART DESCRIPTION	SP#
1	1	LIFT & TURN PLATE	-----
2	2	TROLLEY STOP	SP122
3	2	1" FLAT HEAD RIVET	SP179

TTR = #SW020 ELECTRO-GALV.
ALSO AVAILABLE IN STAINLESS STEEL.

THE ABOVE SWITCHES ARE ALSO AVAILABLE WITH A 45° CURVED TRACK IN LIEU OF A 90° CURVED TRACK. SEE SWITCH OPTIONS LISTED ON PAGE #30.

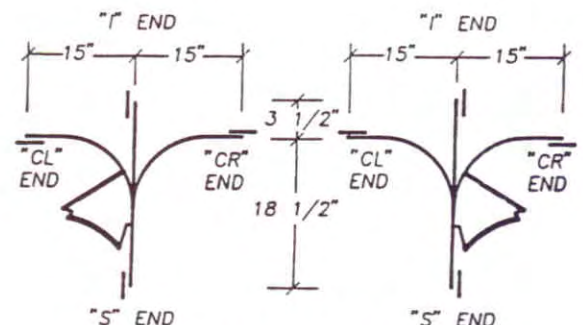

PLAN VIEW

6012 COUNTER WEIGHT SWITCH

MAXIMUM LOAD CAPACITY 1,500 LBS

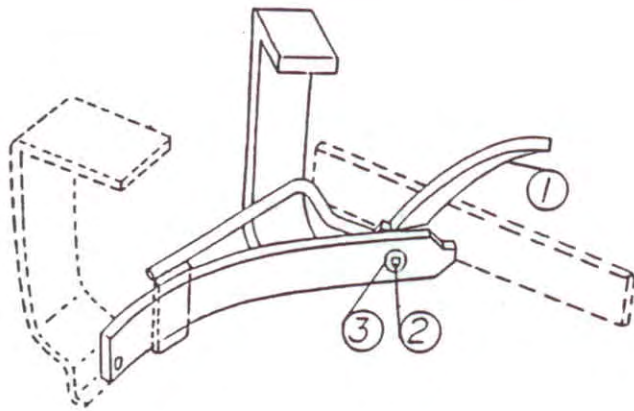

1L REPLACEMENT PARTS

PART	PCS	PART DESCRIPTION	SP#
1	1	LIFT TRACK ASSEMBLY	-----
2	1	LIFT PIVOT BOLT	SP118
3	1	FLEX LOCK NUT	SP120

1L = #SW092 ELECTRO-GALV.
ALSO AVAILABLE IN STAINLESS STEEL.

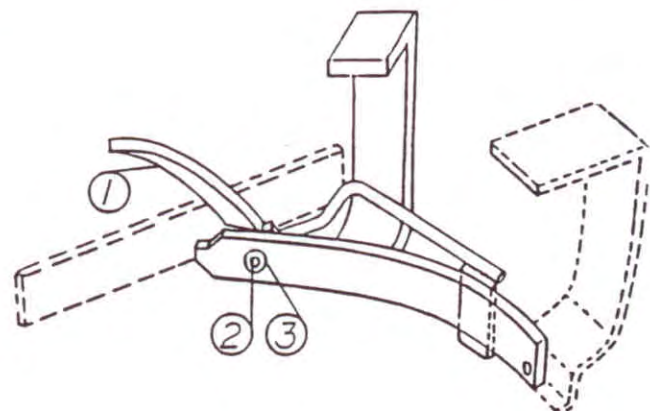

1R REPLACEMENT PARTS

PART	PCS	PART DESCRIPTION	SP#
1	1	LIFT TRACK ASSEMBLY	-----
2	1	LIFT PIVOT BOLT	SP118
3	1	FLEX LOCK NUT	SP120

1R = #SW091 ELECTRO-GALV.
ALSO AVAILABLE IN STAINLESS STEEL.

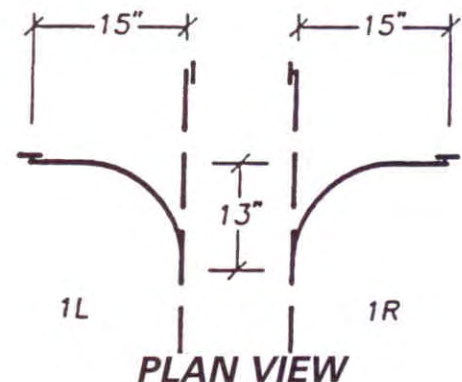

THE ABOVE SWITCHES ARE ALSO AVAILABLE IN STAINLESS STEEL. COUNTER WEIGHT SWITCHES ARE NOT AVAILABLE IN 2L OR 2R.

6607 POWERED DIVERT SWITCH

MAXIMUM LOAD CAPACITY 1,500 LBS

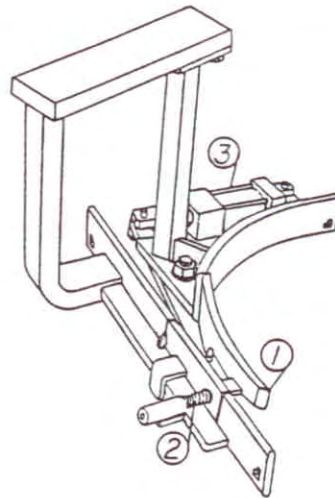
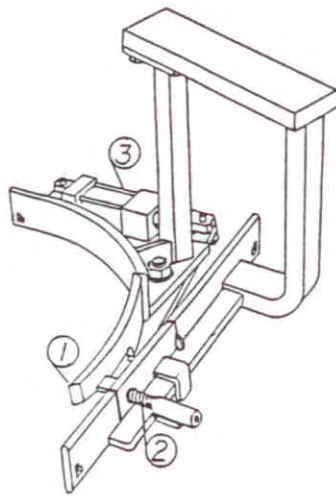

1L-90 REPLACEMENT PARTS

PART	PCS	PART DESCRIPTION	SP#
1	1	MOVING TRACK SECTION	FG977
2	1	SPRING	FG544
3	1	CYLINDER *	-----

1R-90 REPLACEMENT PARTS

PART	PCS	PART DESCRIPTION	SP#
1	1	MOVING TRACK SECTION	FG994
2	1	SPRING	FG544
3	1	CYLINDER *	-----

* CYLINDER CUSTOMER TO SPECIFY.
ALSO AVAILABLE IN STAINLESS STEEL.

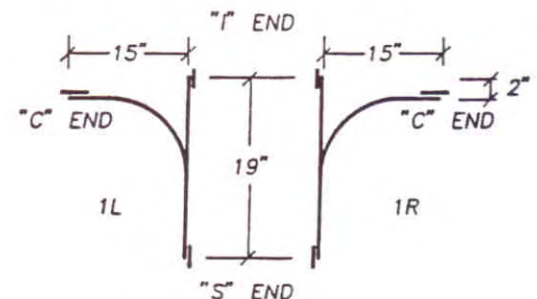

PLAN VIEW

THE ABOVE SWITCHES ARE ALSO AVAILABLE WITH A 45° CURVED TRACK IN LIEU OF A 90° CURVED TRACK. SEE SWITCH OPTIONS LISTED ON PAGE #30.

6607 POWERED DIVERT SWITCH

MAXIMUM LOAD CAPACITY 1,500 LBS

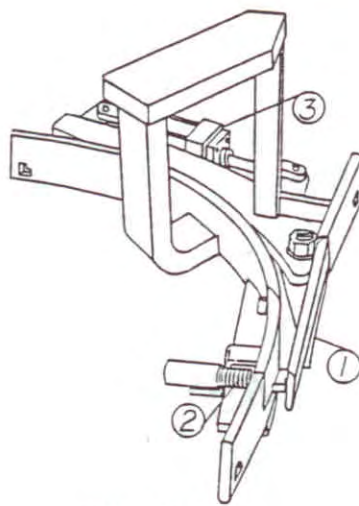

2L-90

2L-90 REPLACEMENT PARTS

PART	PCS	PART DESCRIPTION	SP#
1	1	MOVING TRACK SECTION **	FGC64
2	1	SPRING	FG544
3	1	CYLINDER *	-----

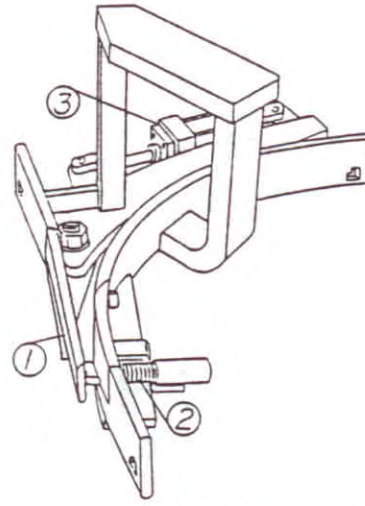

2R-90

2R-90 REPLACEMENT PARTS

PART	PCS	PART DESCRIPTION	SP#
1	1	MOVING TRACK SECTION	FGA17
2	1	SPRING	FG544
3	1	CYLINDER *	-----

* CYLINDER CUSTOMER TO SPECIFY.
 ** OLD STYLE #FG758 (NORMALLY SOLD TO MONFORT-DUMAS).
 ALSO AVAILABLE IN STAINLESS STEEL.

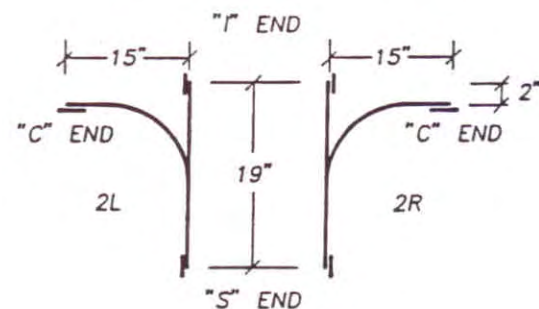

PLAN VIEW

THE ABOVE SWITCHES ARE ALSO AVAILABLE WITH A 45° CURVED TRACK IN LIEU OF A 90° CURVED TRACK. SEE SWITCH OPTIONS LISTED ON PAGE #30.

45° & 60° SWITCH DIMENSIONS

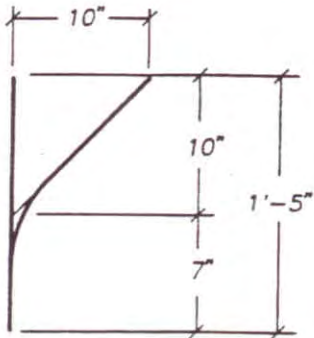

45° SWITCH

6006 - STD. AUTOMATIC #1 & #2
6007 - STD. GEAR OPERATED #1 & #2

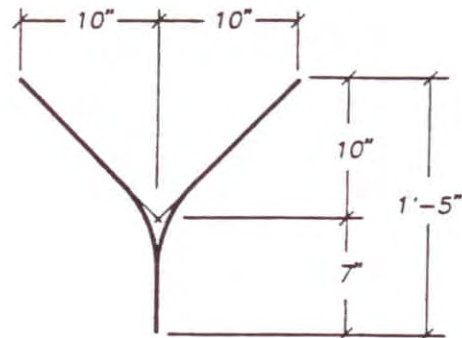

45° SWITCH

6006 - STD. AUTOMATIC #3
6007 - STD. GEAR OPERATED #3

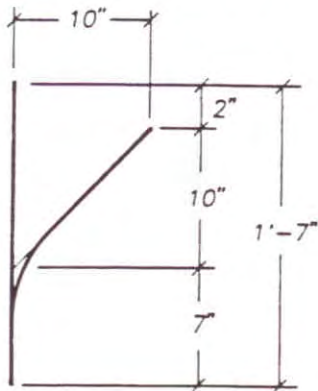

45° SWITCH

6006 - AUTO. CONVEYOR #1 & #2
6007 - GEAR OPERATED CONVEYOR #1 & #2
6607 - DIVERT SWITCHES #1 & #2

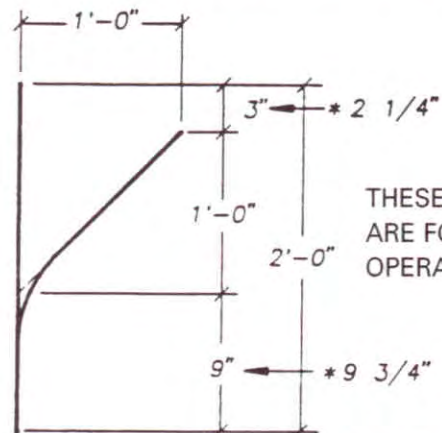

THESE DIMENSIONS
ARE FOR THE GEAR
OPERATED SWITCHES.

45° SWITCH

6008 - AUTO & GEAR OPERATED
BLEED RAIL SWITCHES #3

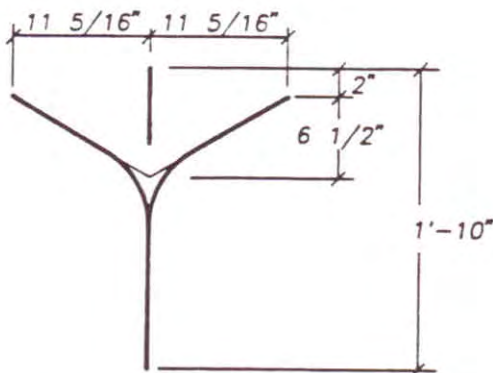

60° SWITCH

6011 - LIFT & TURN

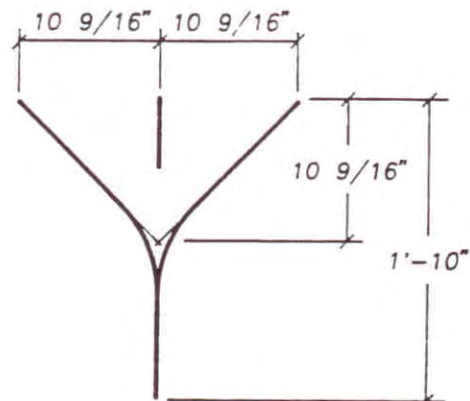

45° SWITCH

6011 - LIFT & TURN

SWITCH OPTIONS

LeFiell offers special options on switches to better fulfill the customers needs. Please specify any special options when ordering switches.

Special switches are custom made and are not returnable.

Options:

- 1) Guard rail (also available on track)
- 2) Shorten one end
- 3) Slope curve up or down
- 4) Tie rods in lieu of links
- 5) Extend one end
- 6) Bolt on bridge
- 7) Extend or shorten yokes
- 8) Cylinder mounted to operate switch
- 9) 45° curved track in lieu of 90°
- 10) Stainless steel construction

TYPICAL GUARD RAIL SWITCH

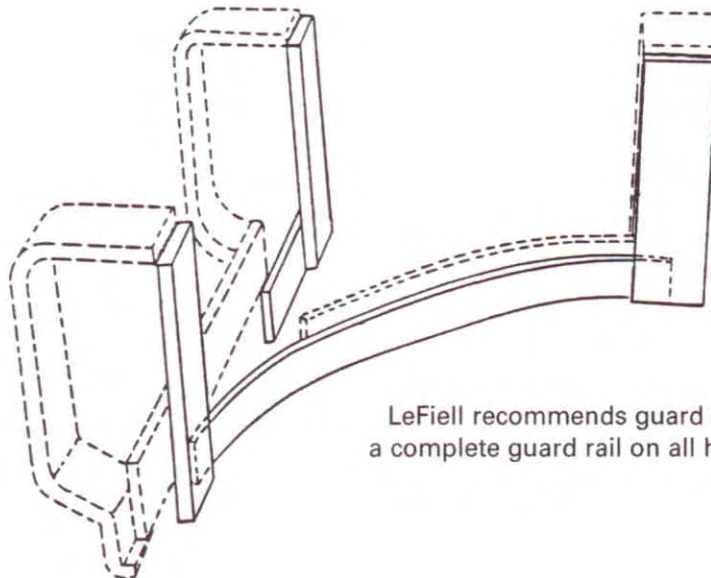

LeFiell recommends guard rail on switches, as well as a complete guard rail on all heavily traveled areas..

SWITCH ACCESSORIES

INV. #	DESCRIPTION
SP040	Direction Selector (in lieu of control weight for #1 & #2 standard automatic switches only)
FC287	Short Galvanized Handle
FG288	Short Plastic Handle
FG289	Long Plastic Handle

SWITCH RELATED EQUIPMENT

LeFiell #6000-1	1/2" x 2 1/2" Round Edge Track
LeFiell #6000-70	Clamp On Trolley Stop
LeFiell #6000-74	Guard Rail
LeFiell #6002	Hot Forged Hangers
LeFiell #6003	Hot Forged Bleeding Rail Hangers
LeFiell #6005	Cold Formed Hangers

See the complete LeFiell company catalog for all your packing house needs.

SWITCH INSTALLATION

Inspect the equipment for any damage as soon as possible after receiving the equipment. Report any damage or shortages to the delivering carrier promptly. Read instructions completely before starting installation.

1) Prior to replacing a switch, block ends of track. In case of a conveyORIZED system lock out electrical motor starter and tag conveyor before installing switch.

2) For a new installation, install three (3) track hangers, of the correct length, to dimensions for the switch to be installed; if a special switch refer to layout drawing. This applies to all switches except #6012 counter weight switches which have only two hangers (straight track is part of continuous head rail), #6006 cut-thru switch (has 4 hangers) and #6807 divert switches which have the same three (3) hangers, but also requires installation of air or hydraulic lines and electrical controls

Note: Switches should be installed prior to track installation.

3) Attach standard and conveyor, automatic and gear operated switch (gear operated switches are not recommended on conveyORIZED systems), to hangers with 3/8" x 1 1/2" carriage bolts for hot forged hangers (3/8" x 1 1/4" for cold formed hangers) inserted through track first and then outside holes in hanger heel. Attach bleed rail switch with 1/2" x 1 3/4" rib neck bolt. Switch track ends are to terminate at centerline of hangers with vertical support section of track hanger located on the same side of the track as switch operating mechanism and switch yoke. If switch is being installed in a system with 3/8" x 2 1/2" track the sides of the switch track ends must be beveled at least 1" to blend with track ends. Replacement switches with bolted bridges require field welding of the bridges

4) Adjust hangers on support beam so that the centerline of all switch track ends are located on centerline of support beam. Determine that the track is seated tightly in the bottom of the hanger. When properly aligned, tighten bolts or lag screws holding hanger to support seam, locking hangers in place.

5) Check operation of switch by moving operating handle from one position to the other. All pivot bolt nuts should be adjusted to allow free movement of pivoting part with minimum of side motion. The curved and straight lift pieces should seat within the locating pieces and in line with the stationary track stub when in the down position. (Note: most switch misalignment is caused by forcing the track into alignment with switch track ends. Be sure track system aligns with switch without force before tightening bolts.)

6) If installing #6006 conveyor switch (tie-rod type switch) the above adjustments are made by tightening or loosening rod ends of links. LeFiell recommends welding switch track ends.

Danger: Do not weld cast iron hangers.

7) All switches should be tested by running a trolley (weight not more than rated capacity) in all directions. The trolley must pass smoothly and not come into contact with operating parts conveyor switch lift pieces should not come into contact with conveyor parts.

SWITCH OPERATION

- 1) Only one trolley at a time should be moved over a switch at a normal walking speed. Always push trolley thru switch never pull.
- 2) When approaching the switch with a loaded trolley from the diverging direction visually determine that lift pieces are positioned to allow trolley to move in the desired direction and that the down piece is properly seated. If necessary, move operating arm to reposition lift pieces to accommodate desired trolley travel.
 - A) The automatic switch eliminates manual operation in gathering to a common headrail (converging). The weight and forward motion of an approaching trolley along either rail activates the switch, if necessary closing one rail and opening the other.
- 4) Never push or convey a trolley onto or over a raised lift track piece of a switch while a trolley is resting on or moving over the other lift track piece of the same switch.
- 5) If gear operated conveyor switches (not recommended for conveyORIZED systems) are used, special care must be taken if the switch is activated while conveyor is moving so drop finger will not come in contact with lifting track piece.

SWITCH MAINTENANCE

- 1) Establish a formal and continuing program to train all personnel in safe operation and proper maintenance procedures.
- 2) Inspect operation of switches weekly to determine that all pivot nuts are properly adjusted and all moving parts are operating freely. See switch installation paragraph #5.
- 3) Immediately replace all parts that become badly worn or damaged. Refer to spec;fc switch page for spare parts list.
- 4) Lubricate monthly all pivot points with small amount of mineral oil (or other light, edible lubricant). Remove excess with rag.

SWITCH SAFETY

LeFiell company switches are designed to operate safely when used for their intended purpose. It is the purchaser's responsibility to ensure proper use of switches and to train operators for its safe and efficient operation. It is recommended that purchaser review the equipment operator's performance periodically.

It is also the purchaser's responsibility to properly install and maintain the switch so that it can be operated safely. All LeFiell switches are affixed with operator warning signs. Be sure that safety rules are observed and the safety signs are maintained.

This manual was written to aid the operations and maintenance personnel in the operation and/or maintenance of LeFiell switches. This section was written to help ensure the safety of the personnel who perform these tasks.

- 1) Rigid head and eye protection is required at all times when working under switches and overhead track systems.
- 2) Do not swing from switches, or use overhead switches, conveyors or track systems as a mode of personal transportation.
- 3) Excessive pushing, pulling or swinging of product is dangerous. Product must be kept directly under trolley and track switch failure to comply could result in metal particles falling from the track, or the trolley to leave the track and fall to the floor.
- 4) Do not exceed load capacity of the switch.
- 5) LeFiell recommends the use of guard rail and guard rail switches in all areas where track and switches are used. And especially in high traffic and high personnel hazard areas.
- 6) All personnel working in and around areas where track and switches are used should be provided with these safety guide lines.

Warning Signs

Warning signs in english and spanish are available upon request directly from LeFiell company telephone number (775) 677-5300.

WARRANTY

"Warranty: the LeFiell company warrants that the equipment to be delivered will be of the kind and quality described in the order or contract and will be free of defects in workmanship or material. Should any failure to conform to this warranty appear within one year after delivery, the LeFiell company shall upon notification thereof and substantiation that the equipment has been stored, installed, maintained and operated in accordance with the corporation's recommendations, not to exceed one shift per day, and standard industry practice, correct such nonconformities including, nonconformance with specifications, at its option, by suitable repair or replacement at LeFiell company's expense. This warranty is in lieu of all warranties of merchantability, fitness for purpose, or other warranty expressed or implied, except of title and against patent infringements. Correction of nonconformities, in the manner and for the period of time provided above, shall constitute fulfillment of all liabilities of the LeFiell company to the purchaser, whether based on contract, negligence or otherwise with respect to, or arising out of such equipment.

"Limitation of Liability; the LeFiell company shall not be liable for special, consequential damages, such as, but not limited to, loss, injury, or damage to person or property resulting from failure or defective operation or any material or equipment furnished hereunder, damage or loss of other property or equipment, loss of profits or revenue, loss or use of power system, cost of capital, cost of purchase or replacement power, or claims of customers of purchaser for service interruption. The remedies of the purchaser set forth herein are exclusive, and the liability of the LeFiell company with respect to any contract or anything done in connection therewith such as the performance or breach thereof, or from the manufacture, sale, delivery, resale, installation or use of any equipment covered by or furnished under this contract whether in contract in tort, under any warranty, or otherwise, shall not, except as expressly provided herein, exceed the price of the equipment or part on which such liability is based. This writing expresses the entire agreement between us and no other agreements, statement or representation shall be binding unless reduced to writing, signed by an officer of this company and attached hereto."